



T74501

## Seismic Luxury Series



Serial #: 1UJCGSCV7R19N0083  
Model: 4113 SEISMIC LUXURY SERIES FW

Model Year: 2024 Dealer Name: RV ONE SUPERSTORES-JACKSONVILLE  
8281 MERRILL RD  
JACKSONVILLE, FL 32277  
USA

**Manufacturer's Suggested Retail Price \$196,206.00**

TOTAL AMOUNT DOES NOT INCLUDE STATE AND LOCAL TAXES OR LICENSE FEES. THE PRICE SHOWN ABOVE MAY OR MAY NOT BE REPRESENTATIVE OF THE ACTUAL SELLING PRICE OF SIMILAR RECREATIONAL VEHICLES IN YOUR AREA.

### Standard Equipment

THE FOLLOWING ITEMS ARE STANDARD ON THIS MODEL AT NO EXTRA CHARGE

- EXTERIOR**
- 102 in. wide-body structural steel I-beam construction
  - Stronghold VBL™ aluminum framed and vacuum bond laminated gelcoated fiberglass exterior walls (including slide room end walls)
  - Climate Shield™ zero-degree tested weather protection:
  - Fully enclosed and heated underbelly (ducted)
  - 40,000 BTU output furnace
  - Double layer fiberglass batt insulation (roof and floor)
  - Helix Cooling System™ (industry exclusive):
  - Two exterior-mounted 15,000 BTU "Whisper Quiet" A/C unit (living room and bedroom)
  - Jayco exclusive insulated dual duct design
  - Larger return air vents with user-accessible filters
  - JaySMART™ (Safety Markers And Reverse Travel) LED lighting (patented)
  - Painted fiberglass front cap with clear coat and built-in specialty LED lighting
  - Custom automotive-grade vinyl exterior graphics package
  - LED exterior lighting package
  - Detachable shore power cord
  - Dual 30 lb. propane bottle with auto regulator
  - Pass-through storage with Slam-latch™ baggage doors
  - Digital TV antenna with Wi-Fi extender
  - Exterior marine-grade speakers with Bluetooth® controller
  - Fully enclosed, LED-lit universal docking center:
  - Quick-connect outside shower
  - Black tank flush
  - Winterization and sanitation
  - Independent satellite wiring
  - Whole coach cable hookups
  - Water heater bypass
  - Battery disconnect
  - Under-mounted spare tire
  - Folding roof ladder
  - JayPort for outside griddle
  - Oversized multi-battery compartment (industry leading room for 4-6 batteries)
  - 3-season removable garage wall
  - MORryde Safe-T-Rail grab handle
  - Magnum Truss™ Roof System (strongest tested roof in the industry) with one piece, seamless roof material with 20 year warranty
  - 5 STAR HANDLING PACKAGE (Mandatory)
  - 17.5 in. 16 ply 'H' rated Uniroyal tires
  - Dextle® Axles with ABS and Tow Assist - includes Nev-R-Adjust® brakes and E-Z Lube® hubs
  - MORryde® pin box
  - MORryde® CRE-3000™ rubberized suspension
  - Wet bolt fasteners, bronze bushings and 4,000 lb. leaf springs
- RAMP AND CARGO EQUIPMENT**
- Rear ramp door and patio with anti-slip, non-skid flooring
  - Tuff-ply, rubberized garage floor liner
  - 2 in. block-foam fully insulated garage floor (industry first)
  - Garage D-rings mounted to steel frame
  - Ram air vents and power roof vent
  - HappiJac® electric-lift queen beds/convertible sofas with folding armrests and cup holders
  - Three seasons garage wall/doors (removable)
  - Dual 30 gal. fuel tanks with timer (1 dedicated to generator)
  - Ramp patio kit with exterior steps
  - Rear electric patio awning

- INTERIOR**
- Solid hardwood slide fascia and cabinet doors
  - Handcrafted hardwood glazed doors, drawers and trim
  - 5/8 in. tongue-and-groove joined plywood floor decking and 3/8 in. tongue-and-groove joined plywood roof decking
  - Residential vinyl flooring (made in the USA)
  - Vinyl flooring in slideouts (no carpet)
  - LED interior lighting throughout
  - SuperSofa with heat, massage, recliners, cup holders and LED lighting
  - Dual USB charging ports (kitchen and bedroom)
  - 12V charging station
  - Carbon monoxide and LP detector
  - LED fireplace with electric space heater (select models)
  - Inverter pre-wire
  - "Shoe garage" in hallway step (select models)
  - Heavy-duty, 75 lb., full-extension, steel ball-bearing drawer guides
  - Stainless steel kitchen sink w/ pull-out sprayer
  - Pull-out spice rack above microwave (select models)
  - 17 cu. ft. 12V refrigerator
  - Residential quilted bedspread and pillows
  - C.P.A.P. prepped bedroom
  - Bathroom skylight
  - LED backlit custom framed mirror and medicine cabinet
  - Porcelain foot flush toilet
  - Custom interior design - Vintage Farmhouse
  - JAYCOMMAND® "Smart RV" system
  - JayVoice voice command system - controls lighting, A/C and furnace
- CUSTOMER VALUE PACKAGE (Mandatory)**
- MORryde® StepAbove™ entrance steps with strut assist (main entrance)
  - 50-amp service and 3rd A/C prep
  - Dual electric awnings with LED lights
  - 16 gal. gas/electric DSI water heater
  - Custom machined aluminum rims
  - Keyed-Alike™ lock system
  - Rooftop and ground solar prep
  - Hidden hinges on cabinet doors
  - 4K Smart LED HDTV with fully digital HDMI® output
  - GE Profile Series residential 24 in. range (3.7 cu. ft. with 9,100 BTU high output burner)
  - Residential king (72 in. x 80 in.) mattress with under-bed storage
  - Bathroom power vent
  - Hydraulic 6-point auto-leveling system with oversized foot pads
  - Automotive style front windshield
  - JAYCOMMAND® "Smart RV" system powered by BMPRO®
  - Fresh Water Drinking System (patented)
  - JBL® home entertainment system with sound bar and subwoofer
  - Residential solid-surface kitchen countertop with bamboo sink cover and strainer
  - GE Profile Series 30 in. residential convection microwave with built in air fryer
  - Night roller shades in living room
  - 39 in. 4K Smart bedroom TV
  - Residential "walk-in" shower with shampoo/soap holder, teak seat and shower tower
  - Backup, main entrance door and side observation security camera prep (includes a power switch in the bedroom to use the optional 7 in. monitor for security)
  - Cellular prep for 4G WiFi repeater and JAYCOMMAND® "Smart RV" system
  - High gloss gelcoated exterior sidewalls
  - Frameless dark tinted safety-glass windows
  - NPS - Powered by Yamaha 6,000 watt generator, gas/C.A.R.B certified
  - Wireless remote control system (includes Bluetooth® wireless interior controls) with dimmer switches
  - Washer/dryer prep

### Optional Equipment

OPTIONAL EQUIPMENT INSTALLED ON THIS VEHICLE BY MANUFACTURER

Base price	161,141.00
FULL BODY VICTORY RED PAINT	13,493.00
USA STANDARDS CUSTOMER VALUE PACKAGE W/15,000 BTU AC & HEAT PUMP	10,950.00
FIVE STAR HANDLING PACKAGE	5,993.00
NO OVERLANDER PACKAGE 15,000 AC DROP IN CARGO	893.00
21 CU. FT. RESIDENTIAL REFRIGERATOR	1,343.00
NO CARGO TV	n/c
GAS/ELECTRIC DSI WATER HEATER	n/c
PRE-WIRED SANICON DUMP SYSTEM	n/c
BACKUP, SIDE AND ENTRY DOOR OBSERVATION CAMERA PREP	n/c
TINTED SAFETY GLASS WINDOWS	n/c
OUTSIDE TAILGATER CAMP KITCHEN	2,393.00
ELECTRONIC DRUM BRAKES	n/c
KING BED	n/c

UNIT TOTAL **196,206.00**

DEALER INSTALLED OPTIONS

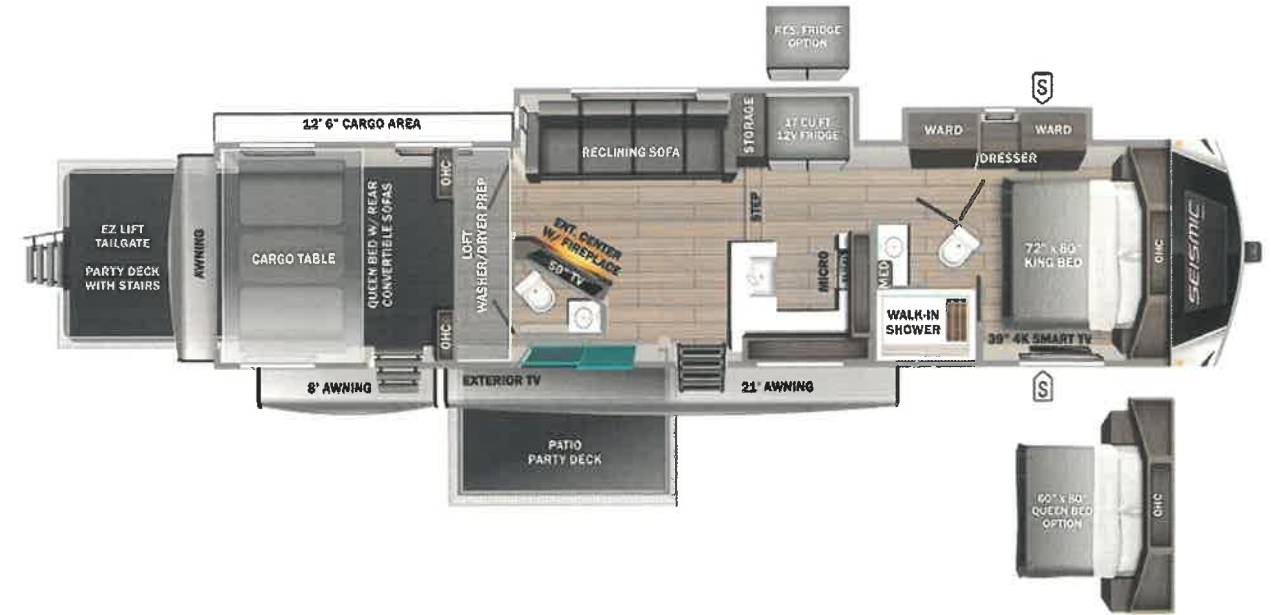

**UVW**  
16696 lbs



**Sleeps**



**Length**  
45' 8.25"

#### DIMENSIONS

Exterior height:	161.00"
Exterior width:	102.00"
GVWR:	20695
GAWR (front):	7000
GAWR (rear):	7000
Approx. Gross Cargo Carrying Capacity (GCCC):	3999

#### TIRES

Tire size (front):	215/75R17.5H
Tire size (mid):	215/75R17.5H
Tire size (rear):	215/75R17.5H
Tire size (spare):	215/75R17.5H

#### CAPACITIES

Fresh water tank (gals.):	106.10
Gray water tank (gals.):	87.00
Black water/toilet tank (gals.):	87.00
Propane (lbs.):	60
Propane (gals.):	14
Water heater (gals.):	16.00

#### SEATING & SLEEPING

\*\*\*Some dimensions may be rounded and may vary from the actual dimensions\*\*\*  
\*\*\*Weights may be estimated calculations and may vary from the actual weight\*\*\*  
- refer to the vehicle weight labels for actual weights\*\*\*  
Floorplans, features and specifications are subject to change without notice.

