



North Point

Serial #: 1UJCD0BV0R1LF0337
Model: 382FLRB NORTH POINT FW

Model Year: 2024 Dealer Name: BLUE COMPASS RV

6775 US 1 SOUTH
ST. AUGUSTINE, FL 32086
USA



Standard Equipment

THE FOLLOWING ITEMS ARE STANDARD ON THIS MODEL AT NO EXTRA CHARGE

- EXTERIOR**
- 12 in. structural steel I-beam with 10 in. steel drop frame
 - Stronghold VBL™ aluminum framed and vacuum bond laminated gelcoated fiberglass exterior walls (including rear wall and slide room end walls)
 - Magnum Truss™ XL6™ Roof System (strongest tested roof in the industry) with Alpha roof membrane system with a limited lifetime warranty
 - Climate Shield™ zero-degree tested weather protection:
 - 40,000 BTU output furnace
 - Double layer fiberglass batt insulation (roof & floor)
 - PEK plumbing, 2 in. block foam & reflective foil
 - JaySMART™ (Safety Markers And Reverse Travel) LED lighting (patented)
 - Painted fiberglass front cap with clear coat and built-in specialty LED lighting
 - Frameless, dark tinted, safety-glass windows
 - Custom automotive-grade vinyl exterior graphics package
 - Shurt metal enclosed drop frame
 - LED exterior lighting package
 - (3) 40 lb. propane bottles with auto regulator (120 lb. max LP system)
 - Pass-through storage with Slam-latch™ baggage doors
 - Digital TV antenna with Wi-Fi extender
 - Exterior marine-grade speakers with Bluetooth® controller
 - Fully enclosed, universal docking center:
 - Selectable water connections
 - Quick-connect outside shower
 - Black tank flush
 - Winterization and sanitation
 - Independent satellite wiring
 - Whole coach cable hooksups
 - Water heater bypass
 - Battery disconnect
 - Under-mounted spare tire
 - JayPort system for outside griddle (all floorplans without a standard outside kitchen)
 - Built in sewer hose carrier
 - Inverter pre-wire to select outlets
 - 102 in. wide body construction
 - 3,000 lb. tow hitch with 4-way pin (N/A 390CKDS)
- CUSTOMER VALUE PACKAGE (Mandatory)**
- 15,000 BTU - Whisper Quiet A/C (main)
 - 15,000 BTU - Whisper Quiet A/C (bedroom)
 - Electric patio awning with integrated LED lights
 - 16 gal. gas/electric DSI water heater
 - Custom machined aluminum rims
 - Keyed-Alike™ lock system (single key for all doors/locks)
 - Rooftop and ground solar prep
 - Backup, main entrance door and side observation security camera prep (includes a power switch in the bedroom to use the optional 7 in. monitor for security)
 - MORyde Safe-T-Rail grab handle
 - 50 in. 4K Smart LED HDTV with fully digital HDMI® output & two extra HDMI cables
 - JBL® home entertainment system with sound bar and subwoofer
 - Hidden hinges on cabinet doors
 - Residential King (72 in. x 80 in.) mattress with under-bed storage
 - Wireless remote control system (includes Bluetooth® wireless controls) with dimmer switches
 - Tire pressure monitoring system

- INTERIOR**
- Solid hardwood slide fascia
 - Handcrafted hardwood glazed doors and drawers
 - 5/8 in. tongue-and-groove joined plywood floor decking (slideout floors)
 - Ceiling fan (select models)
 - LED interior lighting w/ accents above slides
 - Tri-fold hide-a-bed sofa with residential sleep surface (select models)
 - Dual USB charging ports throughout
 - Shoe garage in hallway step (select models)
 - Flip-up tabletop storage next to tri-fold sofa (select models)
 - JayVoice voice command system - controls lighting, A/C and furnace
 - Soft close, heavy-duty, 75 lb. full-extension, steel ball-bearing drawer guides
 - Stainless steel kitchen sink
 - Pull-out spice rack above microwave (select models)
 - Residential-grade, pull-out kitchen faucet
 - Extra 120V power outlets in kitchen and slide rooms
 - Flip-up countertop extension with 24 in. x 24 in. butcher block bar top (select models)
 - Pull-out utility drawer under kitchen sink
 - Toe kick nightlights in bedroom and bathroom
 - Residential quilted bedspread and pillows
 - Gas-structured under-bed storage
 - CPAP prep/ported night stands
 - Carbon monoxide and LP detector
 - Flip-up hidden storage in bedroom chest of drawers (select models)
 - Built-in laundry hamper in wardrobe (select models)
 - Bathroom skylight
 - LED backlit custom framed mirror and medicine cabinet
 - Porcelain toilet with foot flush
 - Vessel bowl sink with high rise faucet in main bathroom
 - True interior design (Modern Farmhouse)
 - LUXURY PACKAGE (Mandatory)
 - 6-point hydraulic auto-leveling system
 - 2nd electric patio awning with integrated LED lights
 - MORyde® StepAbove™ entrance steps with strut assist (main entrance)
 - JAYCOMMAND® "Smart RV" system
 - Cellular prep for 4G Wi-Fi repeater and JAYCOMMAND® "Smart RV" system
 - High gloss gelcoated sidewalls
 - Oversized multi-battery compartment (industry leading room for 4-6 batteries)
 - Flameless dark tinted safety-glass windows
 - Privacy roller shades
 - Free-standing (no pedestal) table with leaf and (2) free-standing and (2) folding chairs
 - LED fireplace with electric space heater
 - Central Vacuum System with dust port
 - Fresh Water Drinking System (connects to ice maker)
 - GE Profile Series 30 in. residential convection microwave with built in air fryer
 - GE 21 cu. ft. residential refrigerator with 1800W inverter
 - GE Profile Series residential 24 in. range (3.7 cu. ft. with 9100 BTU high output burner)
 - Residential solid-surface kitchen countertop with bamboo sink cover and strainer
 - Washer/dryer prep
 - 32 in. 4K Smart bedroom TV
 - Residential walk-in shower with soap holder seat
 - 5 STAR HANDLING PACKAGE (Mandatory)
 - 17.5 in. 16 ply "H" rated Uniroyal tires
 - MORyde® rubber pin box
 - Dexter® Axles with ABS and Tow Assist - includes New-R-Adjust® brakes and E-Z-Lube® hubs
 - MORyde® CRE-3000™ rubberized suspension
 - Wet bolt fasteners, bronze bushings and 4,000 lb. leaf springs

Optional Equipment

OPTIONAL EQUIPMENT INSTALLED ON THIS VEHICLE BY MANUFACTURER

Base price	129,518.00
USA STANDARDS	n/c
CUSTOMER VALUE PACKAGE	
W/15,000 BTU AC & HEAT PUMP	4,875.00
NORTH POINT LUXURY PACKAGE	10,200.00
FIVE STAR HANDLING PACKAGE	5,993.00
NO OVERLANDER PACKAGE	n/c
ROOF VENT	n/c
21 CU. FT. RESIDENTIAL REFRIGERATOR WITH INVERTER	n/c
39" TAILGATE TV IN CARGO AREA	938.00
GENERATOR LP PREP	743.00
GAS/ELECTRIC DSI WATER HEATER	n/c
PRE-WIRED SANICON DUMP SYSTEM	n/c
BACKUP SIDE AND ENTRY DOOR OBSERVATION CAMERA PREP	n/c
TINTED SAFETY GLASS	n/c
WINDOWS	n/c
ROOF LADDER (STD)	n/c
ELECTRONIC DRUM BRAKES	n/c
KING BED	n/c

UNIT TOTAL	152,267.00
DEALER INSTALLED OPTIONS	

Manufacturer's Suggested Retail Price \$152,267.00

TOTAL AMOUNT DOES NOT INCLUDE STATE AND LOCAL TAXES OR LICENSE FEES. THE PRICE SHOWN ABOVE MAY OR MAY NOT BE REPRESENTATIVE OF THE ACTUAL SELLING PRICE OF SIMILAR RECREATIONAL VEHICLES IN YOUR AREA.

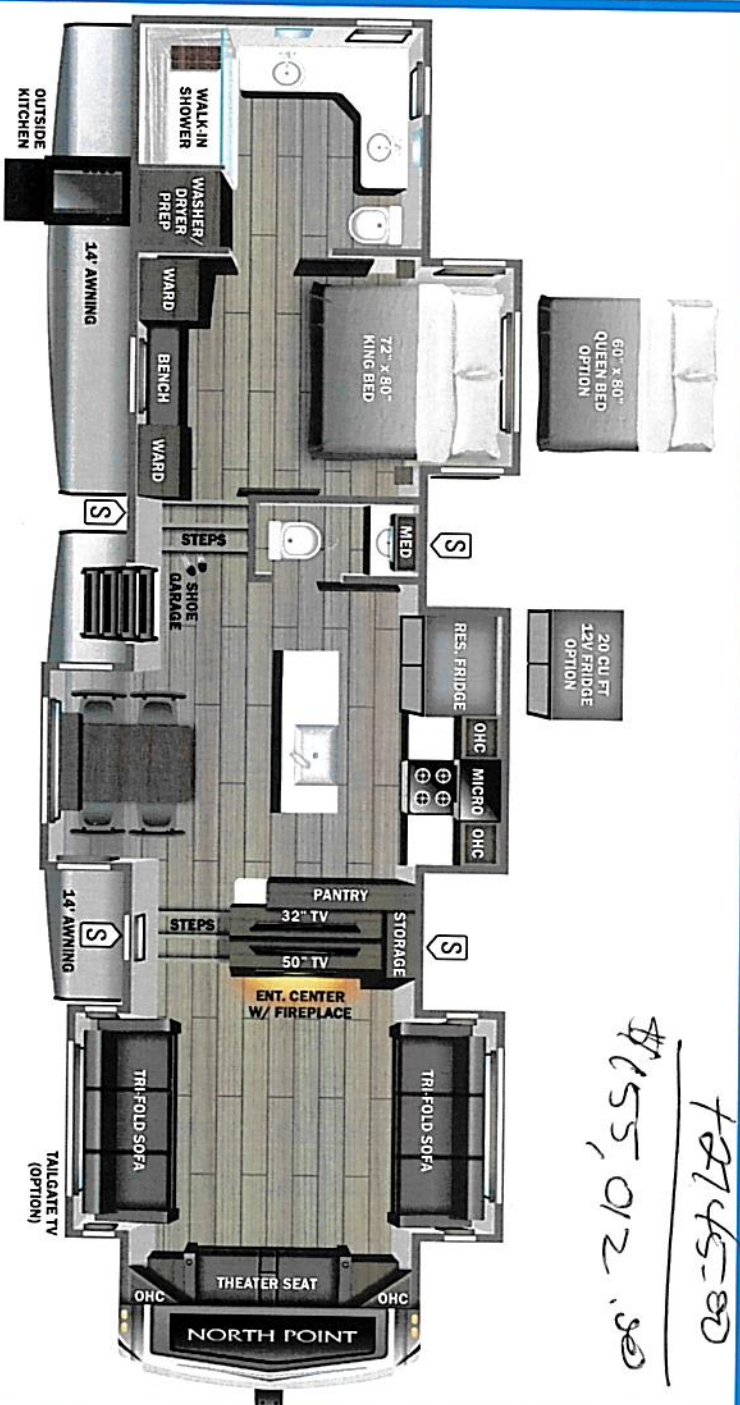

Handwritten notes: \$155,012.80 and 78745=80

UWW 15526 lbs **Sleeps** 43' 9.5" **Length**

- DIMENSIONS**
- Exterior height: 159.75"
 - Exterior width: 102.00"
- WEIGHTS**
- GVWR: 17600
 - GAWR (front): 8000
 - GAWR (rear): 8000
 - Approx. Gross Cargo Carrying Capacity (GCC): 2074
- TIRES**
- Tire size (front): 215/75R17.5H
 - Tire size (mid): 215/75R17.5H
 - Tire size (rear): 215/75R17.5H
 - Tire size (spare): 215/75R17.5H
- CAPACITIES**
- Fresh water tank (gals.): 75.00
 - Gray water tank (gals.): 82.50
 - Black water/coilet tank (gals.): 74.00
 - Propane (lbs.): 120
 - Propane (gals.): 28
 - Water heater (gals.): 16.00
- SEATING & SLEEPING**

Some dimensions may be rounded and may vary from the actual dimensions
 Weights may be estimated calculations and may vary from the actual weight
 - refer to the vehicle weight labels for actual weights***
 Floorplans, features and specifications are subject to change without notice.

