



Seismic

Serial #: 1UJCGSCV1R18L0134  
Model: 395 SEISMIC FW

Model Year: 2024 Dealer Name: BLUE COMPASS RV  
6775 US 1 SOUTH  
ST. AUGUSTINE, FL 32086  
USA

Manufacturer's Suggested Retail Price \$131,304.00

TOTAL AMOUNT DOES NOT INCLUDE STATE AND LOCAL TAXES OR LICENSE FEES. THE PRICE SHOWN ABOVE MAY OR MAY NOT BE REPRESENTATIVE OF THE ACTUAL SELLING PRICE OF SIMILAR RECREATIONAL VEHICLES IN YOUR AREA.

HALFBATH  
OPTION

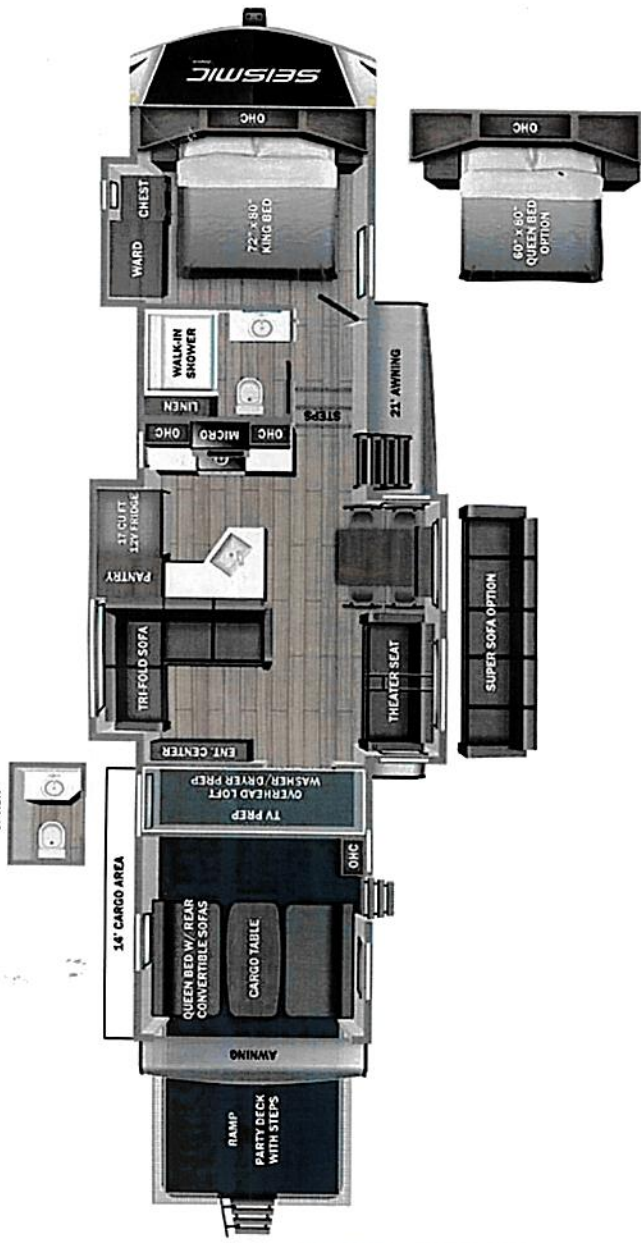

**UVW**  
15220 lbs



**Sleeps**

**Length**  
45' 7"

**Standard Equipment**

THE FOLLOWING ITEMS ARE STANDARD ON THIS MODEL AT NO EXTRA CHARGE

- EXTERIOR**
  - 102 in. wide body structural steel I-beam construction
  - Stronghold/VBL™ aluminum framed and vacuum bond laminated gelcoated fiberglass exterior walls and slide room end walls
  - Climate Shield™ zero-degree tested weather protection.
  - Fully enclosed and heated underbelly (ducted)
  - 35,000 BTU output furnace
  - Double layer fiberglass batt insulation in ceiling and floor
  - Double sided radiant barrier insulation (roof and floor)
  - PEX plumbing
  - HELIX Cooling System™ (industry exclusive):
    - Two exterior-mounted 13,500 BTU ducted A/Cs (living room and bedroom)
  - Jayco-exclusive insulated dual duct design
  - Directional and closeable A/C vents
  - JaySMART™ (Safety Markers And Reverse Travel) LED lighting (patented)
  - Painted fiberglass front cap with clear coat and built-in specialty LED lighting
  - Custom automotive-grade vinyl exterior graphics package
  - Detachable shore power cord
  - Dual 30 lb. propane bottles with auto regulator
  - Pass-through storage with Siam-latch™ baggage doors
  - Digital TV antenna
  - Exterior marine-grade speakers
  - Fully enclosed, LED-lighted universal docking center:
  - Quick-connect outside shower
  - Black tank flush, winterization and sanitation
  - Satellite prep
  - Water heater bypass
  - Battery disconnect switch
  - Under-mounted spare tire
  - LP quick-connect
  - Folding roof ladder
  - 6-point hydraulic auto-leveling system
  - NPS - Powered by Yamaha 6,000 watt generator, gas/C.A.R.B certified
  - Magnum Truss™ Roof System (strongest tested roof in the industry) with Alpha roof membrane system with limited lifetime warranty
- 4 STAR HANDLING PACKAGE (Mandatory)**
  - 17.5 in. 16 ply 'H' rated Uniroyal tires
  - Dexter® Axles with ABS and Tow Assist - includes Nev-R-Adjust® brakes and E-Z Lube® hubs
  - Wet bolt fasteners and bronze bushings and 4,000 lb. leaf springs
  - Rota-flex king pin
- RAMP AND CARGO EQUIPMENT**
  - Rear ramp door and patio with anti-slip, non-skid flooring
  - LED high-intensity ramp lights
  - Tuff-ply, rubberized garage floor liner
  - Garage D-rings mounted to steel frame
  - Ram air vents and power roof vent
  - HappiJacc® electric-lift queen beds/convertible sofas with folding armrests and cup holders
  - Rear patio kit with exterior steps
  - Rear electric patio awning
  - Three seasons removable garage wall/doors
  - 30 gal. fuel tank with timer
- INTERIOR**
  - Solid hardwood cabinet doors, drawers and trim
  - Handcrafted and glazed doors, drawers and trim
  - 5/8 in. tongue-and-groove joined plywood main floor decking and 3/8 in. tongue-and-groove plywood in the roof
  - Residential vinyl flooring (made in the USA)
  - Vinyl flooring in slideouts (no carpet)
  - LED interior lighting throughout
  - Central command center with built-in tank monitoring
  - SuperSofa with heat, massage, and LED lighting
  - 12V charging station
  - Carbon monoxide and LP detector
  - LED fireplace with electric space heater (select models)
  - Two removable cup holder sofa tables
  - Inverter pre-wire
  - Heavy-duty, 75 lb., full-extension, steel ball-bearing drawer guides
  - Stainless steel kitchen sink
  - Kitchen faucet with pull-out sprayer
  - Residential quilted bedspread
  - Gas-structured under-bed storage
  - Hardwood safety handrail on steps
  - Bathroom skylight
  - Porcelain foot flush toilet
  - Washer/dryer prep
  - Custom interior design - Vintage Farmhouse
- CUSTOMER VALUE PACKAGE (Mandatory)**
  - MORfyde® strut-assisted fold-away entrance steps (main entrance)
  - 50-amp service and 3rd A/C prep
  - Electric awning with LED lights
  - 2nd awning
  - 16 gal. gas/electric DSI water heater
  - Custom machined aluminum rims
  - Keyed-Alike™ lock system
  - Roof top and ground solar prep
  - Hidden hinges on cabinet doors
  - Night shades
  - 4K Smart LED HDTV with fully digital HDMI® output
  - AM/FM/CD/DVD/Bluetooth® stereo with 4 speakers
  - Microwave
  - Residential king (72 in. x 80 in.) mattress with under bed storage
  - Bathroom power vent
  - Oven with 3-burner recessed cooktop with glass cover
  - 17 cu. ft. 12V refrigerator

**Optional Equipment**

OPTIONAL EQUIPMENT INSTALLED ON THIS VEHICLE BY MANUFACTURER

- Base price 119,168.00
- USA STANDARDS n/c
- CUSTOMER VALUE PACKAGE 7,500.00
- FOUR STAR HANDLING PACKAGE 3,743.00
- NO OVERLANDER PACKAGE n/c
- POWERED VENT CARGO AREA n/c
- TINTED SAFETY GLASS n/c
- WINDOWS n/c
- THEATER SEAT & DINETTE n/c
- KING BED n/c
- HALF BATH 893.00

UNIT TOTAL **131,304.00**

DEALER INSTALLED OPTIONS

**DIMENSIONS**

Exterior height:.....160.00" Fresh water tank (gals.):...106.10

Exterior width:.....102.00" Gray water tank (gals.):.....87.00

**WEIGHTS**

GVWR:.....19995 Black water/toilet tank (gals.):.....87.00

GAWR (front):.....7000 Propane (lbs.):.....60

GAWR (rear):.....7000 Propane (gals.):.....14

Approx. Gross Cargo Carrying Capacity(GCCC):.....4775 Water heater (gals.):.....16.00

**SEATING & SLEEPING**

**TIRES**

Tire size (front):.....215/75R17.5H

Tire size (mid):.....215/75R17.5H

Tire size (rear):.....215/75R17.5H

Tire size (spare):.....215/75R17.5H

\*\*\*Some dimensions may be rounded and may vary from the actual dimensions\*\*\*  
 \*\*\*Weights may be estimated calculations and may vary from the actual weight  
 - refer to the vehicle weight labels for actual weights\*\*\*  
 Floorplans, features and specifications are subject to change without notice.

