



Jay Flight



Serial #: 1UJBC0BS0R17M0119  
Model: 294QBS JAY FLIGHT TT

Model Year: 2024 Dealer Name: RV One Superstores - Raleigh  
805 Old Roberts Road  
Benson, NC 27504  
USA

Standard Equipment

THE FOLLOWING ITEMS ARE STANDARD ON THIS MODEL  
AT NO EXTRA CHARGE

TERIOR  
0 lb. LP bottles with cover (2)  
nclosed and heated underbelly  
xles with electric, self-adjusting brakes and  
y-lube hubs  
Class™ cambered structural steel I-beams  
8 in. tongue-and-groove plywood floor decking  
lagnum Truss™ Roof system with plywood decking  
eamless one piece roof material  
arge exterior downspouts  
alvanized steel, impact-resistant wheel wells  
0-amp service  
ront diamond plate  
xterior TV mount and bracket  
P quick connect (outside gas grill prep)

- INTERIOR
- 81 in. ceiling height
  - 8 cu. ft. 12V refrigerator
  - Shower/tub surround
  - Solid hardwood cabinet doors
  - J-Steel™ jackknife sofa with armrest & cup holders (most models)
  - Vinyl flooring throughout (including slide floors)
  - Window shades
  - Residential-style kitchen countertops
  - Heavy-duty, 75 lb., full-extension, steel ball-bearing drawer guides
  - USB charging station
  - Queen mattress
  - Plywood bed platforms
  - Main bed struts
  - 300 lb. rated bunk beds (select models)
  - 600 lb. rated bunk beds (double bunks)
  - Privacy curtains in bunk areas (select models)
  - Vented bunk windows (select models)
  - 4 in. thick bunk mats (select models)
  - Wooden bedroom doors (select models)
  - Shower curtain with curved shower track (select models)

- CUSTOMER VALUE PACKAGE (Mandatory)
- Black tank flush
  - Overlander 1 Solar Package: (1) 200W solar panel and 30-amp digital controller
  - Large main entry door grab handle
  - Solid Step® entry steps (N/A 380DQS)
  - On-demand tankless water heater
  - Goodyear® Endurance® tires (made in the USA)
  - Outside shower
  - Power tongue jack
  - Spare tire with cover
  - Power awning with LED lights
  - Marine grade exterior speakers
  - Keyed-Alike™ entry and baggage doors
  - Bathroom power vent
  - Bathroom skylight
  - 13.5K BTU A/C
  - AM/FM/Bluetooth® stereo
  - Backup and side view camera prep
  - Bathroom medicine cabinet
  - Detachable power cord
  - Fitted bed sheet
  - Friction hinge entry door with window and shade prep
  - G20 dark tinted privacy windows
  - Inverter pre-wire
  - LED exterior and interior lights
  - Marine grade exterior speakers
  - Microwave oven
  - One-piece front fiberglass exterior wall
  - Oven with 3-burner recessed cooktop with glass cover
  - Range hood
  - Rock-Solid Stabilizer System
  - Seamless countertops
  - Sink cover

Optional Equipment

OPTIONAL EQUIPMENT INSTALLED ON THIS VEHICLE  
BY MANUFACTURER

Base price	41,201.00
USA STANDARDS	n/c
CUSTOMER VALUE PACKAGE	5,250.00
15,000 BTU AC	300.00
NO 2ND AC	n/c
50 AMP SERVICE	443.00
METAL SIDEWALL	n/c
BLACK SPOKE RIMS	n/c
20# LP GAS BOTTLES	n/c
JACK KNIFE SOFA	n/c

UNIT TOTAL 47,194.00

DEALER INSTALLED OPTIONS

Manufacturer's Suggested Retail Price \$47,194.00

TOTAL AMOUNT DOES NOT INCLUDE STATE AND LOCAL TAXES OR LICENSE FEES. THE PRICE SHOWN ABOVE MAY OR MAY NOT BE REPRESENTATIVE OF THE ACTUAL SELLING PRICE OF SIMILAR RECREATIONAL VEHICLES IN YOUR AREA.

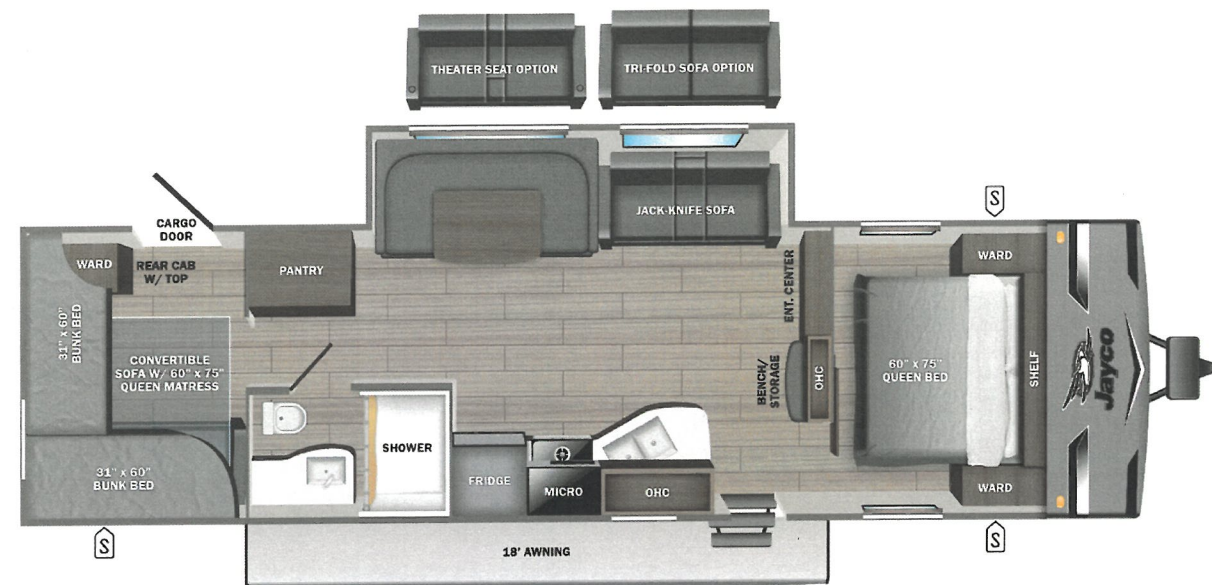

UVW  
6790 lbs



Sleeps



Length  
35' 6.75"

DIMENSIONS

Exterior height:.....135.00"

Exterior width:.....96.25"

WEIGHTS

GVWR:.....8250

GAWR (front):.....4400

GAWR (rear):.....4400

Approx. Gross Cargo Carrying Capacity(GCCC):.....1460

TIRES

Tire size (front):.....ST225/75R15E

Tire size (mid):.....

Tire size (rear):.....ST225/75R15E

Tire size (spare):.....ST225/75R15E

CAPACITIES

Fresh water tank (gals.):...52.00

Gray water tank (gals.):...39.00

Black water/toilet tank (gals.):.....39.00

Propane (lbs.):.....40

Propane (gals.):.....9

Water heater (gals.):.....0.00

SEATING & SLEEPING

\*\*\*Some dimensions may be rounded and may vary from the acutal dimensions\*\*\*

\*\*\*Weights may be estimated calculations and may vary from the actual weight

- refer to the vehicle weight labels for actual weights\*\*\*

Floorplans, features and specifications are subject to change without notice.

