

114-Tel964



Seismic Luxury Series



Serial #: 1UJCGSBV7P19U0071  
Model: 3512 SEISMIC LUXURY SERIES FW

Model Year: 2023 Dealer Name: RV One Superstores - Raleigh  
805 OLD ROBERTS ROAD  
Benson, NC 27504  
USA

Standard Equipment

Optional Equipment

THE FOLLOWING ITEMS ARE STANDARD ON THIS MODEL  
AT NO EXTRA CHARGE

OPTIONAL EQUIPMENT INSTALLED ON THIS VEHICLE  
BY MANUFACTURER

- EXTERIOR**
- 102 in. wide-body structural steel I-beam construction
  - Stronghold VBL™ aluminum framed and vacuum bond laminated gelcoated fiberglass exterior walls (including slide room end walls)
  - Magnum Truss™ (strongest tested roof in the industry) with one piece, seamless roof material with 20 year warranty
  - Climate Shield™ zero-degree tested weather protection:
  - Fully enclosed and heated underbelly (ducted)
  - 40,000 BTU output furnace
  - Double layer fiberglass batt insulation (roof and floor)
  - PEX plumbing
  - Helix Cooling System™ (industry exclusive):
  - Two exterior-mounted 15,000 BTU "Whisper Quiet" A/C unit (living room and bedroom)
  - Jayco exclusive insulated dual duct design
  - Directional and closeable A/C vents
  - Larger return air vents with user-accessible filters
  - JaySMART™ (Safety Markers And Reverse Travel) LED lighting (patent-pending)
  - Painted fiberglass front cap with double clear coat and built-in specialty LED lighting
  - Custom automotive-grade vinyl exterior graphics package
  - LED exterior lighting package
  - Detachable shore power cord
  - Dual 30 lb. propane bottle with auto regulator
  - Pass-through storage with Slam-latch™ baggage doors
  - Digital TV antenna with Wi-Fi extender
  - Exterior marine-grade speakers
  - Fully enclosed, LED-lit universal docking center:
  - Quick-connect outside shower
  - Black tank flush
  - Winterization and sanitation
  - Independent satellite wiring
  - Whole coach cable hookups
  - Water heater bypass
  - Battery disconnect
  - Under-mounted spare tire (16 in. Goodyear® Endurance tire)
  - Folding roof ladder
  - JayPort for outside griddle
  - Oversized multi-battery compartment (industry leading room for 4-6 batteries)
  - 3-season removable garage wall
- RAMP AND CARGO EQUIPMENT**
- Rear ramp door and patio with anti-slip, non-skid flooring
  - LED high-intensity ramp lights
  - Tuff-ply, rubberized garage floor liner
  - 2 in. block-foam fully insulated garage floor (industry first)
  - Garage D-rings mounted to steel frame
  - Ram air vents and power roof vent
  - HappiJac® electric-lift queen beds/convertible sofas with folding armrests and cup holders
  - Three seasons garage wall/doors (removable)
  - Dual 30 gal. fuel tanks with timer (1 dedicated to generator)
  - Ramp patio kit with exterior steps
  - Rear patio awning
- 5 STAR HANDLING PACKAGE (MANDATORY)**
- 17.5 in. Uniroyal H rated tires
  - Dexter® axles with Nev-R-Adjust® brakes, E-Z Lube® hubs, & 4000 lb. leaf springs
  - MORryde® pin box
  - MORryde® CRE-3000™ rubberized suspension
  - Wet bolt fasteners and bronze bushings

- INTERIOR**
- Solid hardwood slide fascia and cabinet doors
  - Handcrafted hardwood glazed doors, drawers and trim
  - 5/8 in. tongue-and-groove joined plywood floor decking and 3/8 in. tongue-and-groove joined plywood roof decking
  - Residential vinyl flooring (made in the USA)
  - Vinyl flooring in slideouts (no carpet)
  - LED interior lighting throughout
  - SuperSofa with heat, massage, recliners, cup holders and LED lighting
  - Two removable cup holder sofa tables
  - Dual USB charging ports (kitchen and bedroom)
  - 12V charging station
  - Carbon monoxide and LP detector
  - LED fireplace with electric space heater (select models)
  - Inverter pre-wire
  - "Shoe garage" in hallway step (select models)
  - Heavy-duty, 75 lb., full-extension, steel ball-bearing drawer guides
  - Stainless steel kitchen sink w/ pull-out sprayer
  - Pull-out spice rack above microwave (select models)
  - 17 cu. ft. 12V refrigerator
  - Residential quilted bedspread and pillows
  - Gas-strutted under-bed storage
  - Hardwood safety handrail on steps
  - C.P.A.P. prepped bedroom
  - Bathroom skylight
  - Medicine cabinet with custom framed LED backlit mirror
  - Bathroom tile backsplash
  - Porcelain foot flush toilet
  - Bathroom hallway window
- CUSTOMER VALUE PACKAGE (MANDATORY)**
- MORryde® StepAbove™ entrance steps with strut assist (main entrance)
  - 50-amp service and 3rd A/C prep
  - Dual electric awnings with LED lights
  - Quick recovery gas/electric DSI water heater
  - Custom machined aluminum rims
  - Keyed-Alike™ lock system
  - Rooftop and ground solar prep
  - Hidden hinges on cabinet doors
  - 4K Smart LED HDTV with fully digital HDMI® output
  - Residential Insignia™ stove (3.73 cu. ft.) with 12K BTU high output burner
  - Residential king (72 in. x 80 in.) mattress with under-bed storage
  - Bathroom power vent
  - Hydraulic 6-point auto-leveling system with oversized foot pads
  - Automotive style front windshield
  - JAYCOMMAND® "Smart RV" system powered by BMPRO®
  - Fresh Water Drinking System (patent-pending)
  - Home entertainment system with subwoofer
  - Residential solid-surface kitchen countertop with bamboo sink cover and strainer
  - 30 in. residential microwave
  - Night roller shades in living room
  - 39 in. 4K Smart bedroom TV
  - Residential "walk-in" shower with shampoo/soap holder, teak seat and shower tower
  - Backup, main entrance door and side observation security camera prep (includes a power switch in the bedroom to use the optional 7 in. monitor for security)
  - Cellular prep for 4G WiFi repeater and JAYCOMMAND® "Smart RV" system
  - High gloss gelcoated exterior sidewalls
  - Frameless dark tinted safety-glass windows
  - 5,500W Onan® gas generator (CARB-certified)
  - Wireless remote control system (includes Bluetooth® wireless interior controls) with dimmer switches
  - Refrigerator temperature sensors linked to JAYCOMMAND®
  - Washer/dryer prep

Base price	144,818.00
Modern Farmhouse	n/c
Graphics	n/c
USA Standards	n/c
Customer Value Package w/15,000 BTU AC & Heat Pump	10,950.00
Five Star Handling Package	n/c
No Overlander Package	n/c
15,000 AC Drop in Cargo	893.00
21 Cu. Ft. Residential Refrigerator	593.00
No Cargo TV	n/c
12 Gal DSI Water Heater	n/c
Pre-Wired Sanicon Dump System	n/c
Backup, Side and Entry Door Observation Camera Prep	n/c
Tinted Safety Glass	n/c
Windows	n/c
Electronic Drum Brakes	n/c
King Bed	n/c

UNIT TOTAL 157,254.00

DEALER INSTALLED OPTIONS

Manufacturer's Suggested Retail Price \$157,254.00

TOTAL AMOUNT DOES NOT INCLUDE STATE AND LOCAL TAXES OR LICENSE FEES. THE PRICE SHOWN ABOVE MAY OR MAY NOT BE REPRESENTATIVE OF THE ACTUAL SELLING PRICE OF SIMILAR RECREATIONAL VEHICLES IN YOUR AREA.

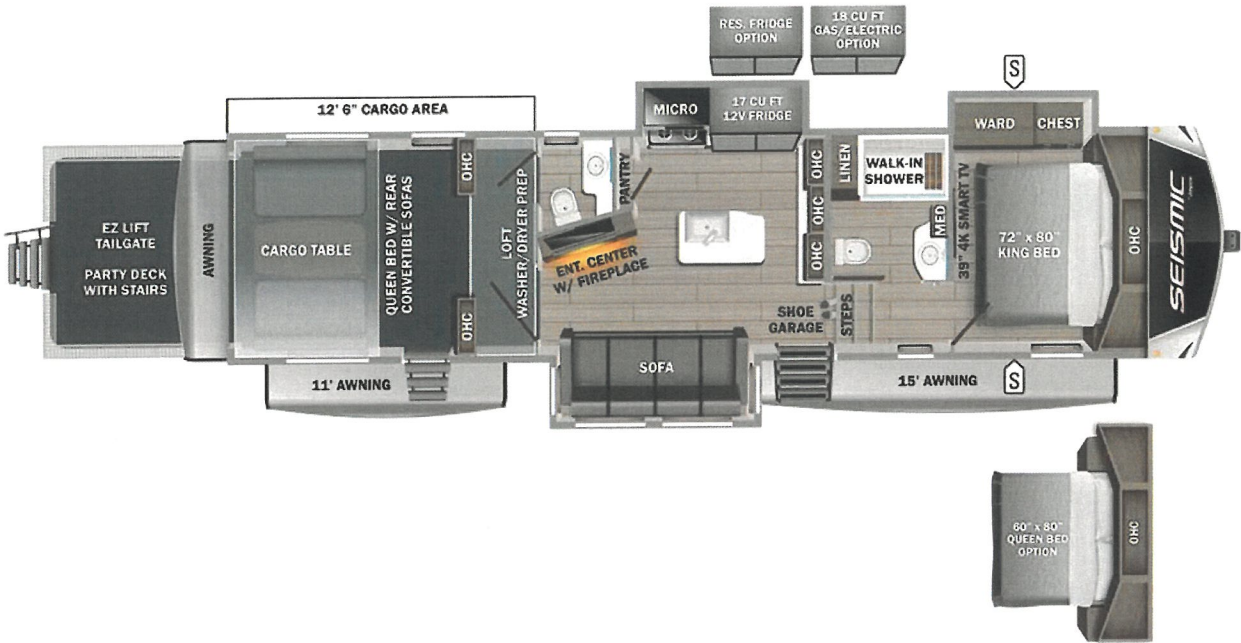

**UVW**  
14721 lbs

**Sleeps**  
6

**Length**  
41' 9.5"

DIMENSIONS	CAPACITIES
Exterior height:.....158.25"	Fresh water tank (gals.):...106.10
Exterior width:.....102.00"	Gray water tank (gals.):....87.00
WEIGHTS	Black water/toilet tank (gals.):.....87.00
GVWR:.....17500	Propane (lbs.):.....60
GAWR (front):.....7400	Propane (gals.):.....14
GAWR (rear):.....7400	Water heater (gals.):.....12.00
Approx. Gross Cargo Carrying Capacity (GCCC):.....2779	SEATING & SLEEPING
TIRES	
Tire size (front):.....215/75R17.5H	
Tire size (mid):.....	
Tire size (rear):.....215/75R17.5H	
Tire size (spare):.....215/75R17.5H	

\*\*\*Some dimensions may be rounded and may vary from the actual dimensions\*\*\*  
\*\*\*Weights may be estimated calculations and may vary from the actual weight\*\*\*  
- refer to the vehicle weight labels for actual weights\*\*\*  
Floorplans, features and specifications are subject to change without notice.

