

T50537



Olympia



Serial #: 58TBH0BP0N14L3312  
Model: 26BHS OLYMPIA TT  
Model Year: 2022 Dealer Name: ALBANY RV  
48 RENSSELAER AVE  
LATHAM, NY 12110  
USA

Manufacturer's Suggested Retail Price \$36,721.00

TOTAL AMOUNT DOES NOT INCLUDE STATE AND LOCAL TAXES OR LICENSE FEES. THE PRICE SHOWN ABOVE MAY OR MAY NOT BE REPRESENTATIVE OF THE ACTUAL SELLING PRICE OF SIMILAR RECREATIONAL VEHICLES IN YOUR AREA.

Standard Equipment

Optional Equipment

THE FOLLOWING ITEMS ARE STANDARD ON THIS MODEL AT NO EXTRA CHARGE

OPTIONAL EQUIPMENT INSTALLED ON THIS VEHICLE BY MANUFACTURER

- EXTERIOR
- 120 GFCI protected receptacle
  - 5/8" main floor decking
  - 96" exterior width
  - Black front diamond plate protection
  - Detachable power cords
  - Exterior docking center (dual axle models)
  - Fiberglass insulation
  - Flexible LP lines
  - Galvanized wheel wells
  - Grab handle
  - In-frame battery rack
  - Magnetic baggage door catches
  - Magnum Roof™ system
  - Marine grade exterior speakers (2)
  - Rain guttering with molded drip spouts
  - Rear camera prep
  - Safety bumper with drain hose carrier and end caps
  - Self-adjusting electric brakes and E-Z Lube® axles
  - Thermal Seal - enclosed, insulated and heated underbelly and PVC roofing membrane with a limited lifetime warranty
  - Tinted safety-glass windows throughout
- RVR PACKAGE (MANDATORY)
- 7-way plug and safety chain holder
  - Baggage door frame with hinge cover and magnetic catch
  - Dinette storage doors
  - Easy lift main bed with storage below
  - Kitchen backsplash
  - Pressed membrane countertops in kitchen and bathroom
  - Residential kitchen faucet with pull-down sprayer
  - Roller blackout night shades
  - Sofa pillows (2)
  - Solid swing-down entry step
  - Tough finish residential vinyl flooring throughout
  - TV mount/hook up

- INTERIOR
- 75 lb. ball bearing drawer guides
  - 81" interior height
  - AM/FM/Bluetooth® radio with indoor/outdoor zoned speakers
  - Cable and satellite prep
  - Closable A/C vents
  - Flush floor slides with residential vinyl flooring
  - Foot flush toilet
  - Hardwood cabinet doors
  - Kid and pet friendly – residential vinyl flooring throughout, vinyl furniture
  - LED interior lighting
  - Pocket-screwed lumbercore cabinet construction
  - Range hood
  - Single basin under-mount kitchen sink
- CUSTOMER CONVENIENCE PACKAGE
- 13,500 BTU roof mounted A/C
  - 17" oven (dual axle models)
  - 2-burner range (Sport models)
  - 3-burner range with glass cover (dual axle models)
  - Digital TV antenna
  - Gas/electric DSI water heater
  - Microwave
  - Nitrogen filled radial tires
  - Power awning with LED lighting
  - Powered bathroom vent
  - Solar prep
  - Stabilizer jacks
  - Water heater bypass

Base price	29,025.00
USA Standards	n/c
Customer Convenience Package	3,743.00
RVR Package	1,275.00
Solar Power Package	525.00
RVIA	135.00
15,000 BTU AC	300.00
13,500 BTU 2nd AC Ducted	825.00
6 Cu. Ft. Gas/Electric	
RV Refrigerator	n/c
LED 32" TV	893.00
Manual Stab Jacks	n/c

UNIT TOTAL 36,721.00

DEALER INSTALLED OPTIONS

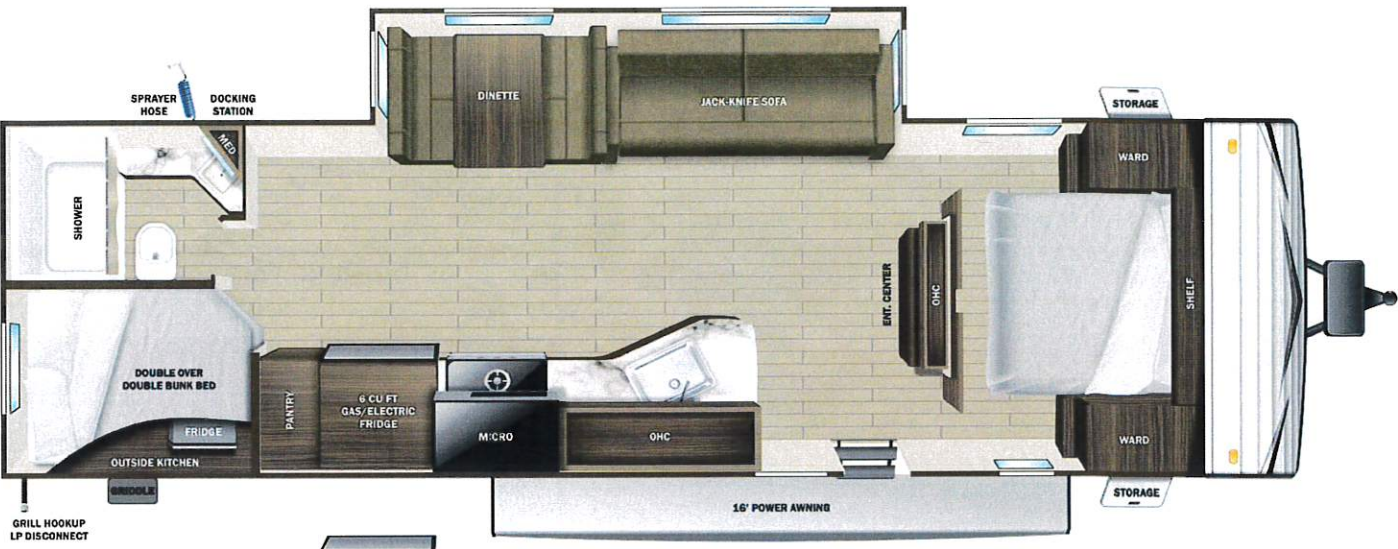

**UVW**  
5974 lbs

**Sleeps**

**Length**  
30' 8.88"

DIMENSIONS

Exterior height:.....132.38"  
Exterior width:.....96.00"  
**WEIGHTS**  
GVWR:.....7500  
GAWR (front):.....3500  
GAWR (rear):.....3500  
Approx. Gross Cargo Carrying Capacity(GCCC):.....1526

CAPACITIES

Fresh water tank (gals.):...42.00  
Gray water tank (gals.):...32.50  
Black water/toilet tank (gals.):...32.50  
Propane (lbs.):.....60  
Propane (gals.):.....14  
Water heater (gals.):.....6.00

SEATING & SLEEPING

TIRES

Tire size (front):.....ST205/75R15D  
Tire size (mid):.....  
Tire size (rear):.....ST205/75R15D

\*\*\*Some dimensions may be rounded and may vary from the actual dimensions\*\*\*  
\*\*\*Weights may be estimated calculations and may vary from the actual weight - refer to the vehicle weight labels for actual weights\*\*\*  
Floorplans, features and specifications are subject to change without notice.

