



Jay Feather

Serial #: 1UJB,JOBM2N1J40235  
Model #: 22RB JAY FEATHER TT

Model Year: 2022

Dealer Name: RV One Superstores Ft. Myers

19065 S. Tamiami Trail  
Fort Myers, FL 33908  
USA



Standard Equipment

THE FOLLOWING ITEMS ARE STANDARD ON THIS MODEL  
AT NO EXTRA CHARGE

- EXTERIOR**
- Aerodynamic, rounded front profile with diamond side moldings
  - Modern retro graphics package with two-colored sidewall
  - Stronghold VRL™ vacuum-bonded, laminated floor & wall
  - Koyed-Alloy™ composite in perimeter walls
  - Magnium Truss™ Roof System with one-piece stainless roof material with 20 year warranty
  - Di-al axle
  - G20 lined safety-glass windows
  - Marine-grade exterior speakers with blue LED
  - Galvalume® (G) and impact-resistant wheel wells
  - 30-amp service
  - Outside grill propane quick-connect port standard on 22RB model only (G20 only)
  - Outside camp kitchen (select models)
  - Battery quick disconnect
  - LED lighting throughout
  - Estator™ TV bracket with 15W electric slide cables outlets
- INTERIOR**
- Choice of two interior design packages- Modern/Farmhouse or Vintage/Washed Gray
  - LED lighting throughout
  - Decorative vinyl floor inlets (select overhead cabinets)
  - Screwed and glued cabinetry
  - Residential vinyl flooring with cold crack resistance
  - Decorative wall clock (select models) (applicable models)
  - Ball-bearing drawer guides with 75 lb. capacity
  - 6 cu. ft. gas/electric refrigerator
  - Residential oven with 3-burner recessed cooktop and glass
  - Residential-style kitchen counter tops
  - Microwave back splash
  - Decorative cushions with vinyl backing
  - Hyco exclusive Ready Bear "soft-hout" residential style bed mats (select models)
  - 220 volt and 120 volt outlets (bunk models only)
  - Bath skylight and roof vent
- CUSTOMER VALUE PACKAGE (MANDATORY)**
- Aluminum tires
  - 24 oz. popper bottles with auto regulator (2)
  - 24 oz. popper (4)
  - Spare tire
  - Detachable power cord
  - Power awning with LED lights
  - 32 in. or 40 in. LED TV
  - Outside shower
  - Power tongue jack
  - Patented stabilizer jacks (4)
  - 55 gal. fresh water tank
  - AM/FM/Bluetooth® stereo
  - Blue camera prep
  - Blue camera (prep)
  - Inverter pre-wire

Optional Equipment

OPTIONAL EQUIPMENT INSTALLED ON THIS VEHICLE  
BY MANUFACTURER

Base price	45,405.00
Modern Farmhouse	n/c
USA Standards	n/c
Customer Value Package	4,875.00
Sport Package	n/c
Solar Power Package Prep	n/c
No JayCommand Control System	n/c
30 Amp Service	n/c
80 Ft. Ft. 12V	293.00
Reductor	n/c
209L Gas Bottles	n/c
Front Ladder (Std)	n/c
Theater Seating w/ Table	893.00

UNIT TOTAL 51,466.00

DEALER INSTALLED OPTIONS

Manufacturer's Suggested Retail Price \$51,466.00

TOTAL AMOUNT DOES NOT INCLUDE STATE AND LOCAL TAXES OR LICENSE FEES. THE PRICE SHOWN ABOVE MAY OR MAY NOT BE REPRESENTATIVE OF THE ACTUAL SELLING PRICE OF SIMILAR RECREATIONAL VEHICLES IN YOUR AREA.

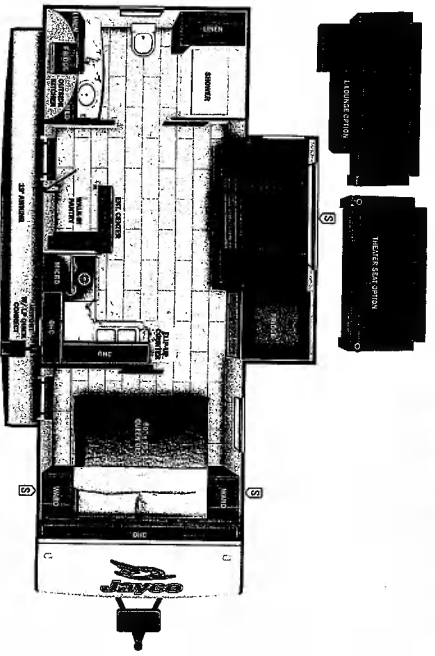

**UVW** 5668 lbs **Sleeps** 2-3 **Length** 27' 8.88"

- DIMENSIONS**
- Exterior height: 128.00"
  - Exterior width: 95.88"
  - Gray water tank (gals.): 55.00
  - Black water/toilet tank (gals.): 61.00
  - Black water tank (gals.): 22.50
  - Proppane (lbs.): 40
  - Proppane (gals.): 9
  - Water heater (gals.): 6.00
- WEIGHTS**
- GVWR: 6750
  - GVWR (Front): 3500
  - GVWR (rear): 3500
  - Approx. Gross Cargo Carrying Capacity (GVCC): 1082
- TIRES**
- Tire size (front): ST205/75R14D
  - Tire size (mid): ST205/75R14D
  - Tire size (rear): ST205/75R14D
  - Tire size (spare): ST205/75R14D
- CAPACITIES**
- Fresh water tank (gals.): 55.00
  - Gray water tank (gals.): 61.00
  - Black water/toilet tank (gals.): 22.50
  - Proppane (lbs.): 40
  - Proppane (gals.): 9
  - Water heater (gals.): 6.00
- SEATING & SLEEPING**

\*\*\*Some dimensions may be rounded and may vary from the actual dimensions\*\*\*  
\*\*\*Weights may be estimated calculations and may vary from the actual weight\*\*\*  
- refer to the vehicle weight labels for actual weights\*\*\*  
Floorplans, features and specifications are subject to change without notice.



T59300