

T34675



Jay Feather

Serial #: 1UUBJ0B8M8N1J40112
 Model: 22RB JAY FEATHER TT
 Model Year: 2022 Dealer Name: RV One Superstores Ft. Myers
 16065 S. Tamiami Trail
 Fort Myers, FL 33908
 USA



Standard Equipment
 AT NO EXTRA CHARGE

EXTERIOR

- Aerodynamic, rounded front profile with diamond pipe trim and graphics package with two-colored sidewall
- Stronghold VRL™ vacuum-bonded, laminated floor & vinyl wall composite in perimeter walls
- Magnum Truss™ Roof System with one-piece seamless roof material with 20 year warranty
- Dual awnings with integrated A-frame
- 020 tinted safety glass windows
- Marine-grade exterior speakers with blue LED lighting (2)
- 09-amp service
- Outside grill propane quick-connect port standard 22RB only (2) (Chryslers StepAbove™)
- Outside camp kitchen (selected models)
- Battery quick disconnect
- 60-amp surge panel (select models with slide rooms)
- Exit door TV (selected with 12V stereo and cable outlets)

SPORT PACKAGE (MANDATORY)

- Aluminum wheels
- Enhanced graphics package
- Front molded fiberglass cap
- Glacier paint color prep
- Glacier paint finishes enclosed underneath
- 32 in. or 40 in. LED TV
- Drying rack/sink cover
- Power roof vent (main living area)

OPTIONAL EQUIPMENT INSTALLED ON THIS VEHICLE BY MANUFACTURER

INTERIOR

- Choice of two interior design packages- Modern Farmhouse or Vintage Washed Gray
- LED lighting throughout
- Spray-on protective urethane finish (select overhead cabinets)
- Sealed and glued cabinetry
- Recreational vinyl flooring with cork crack-resistance
- Recreational wall clock (select models)
- Ply-bearing drawer guides with 75 lb. capacity
- 6 cu. ft. gas/electric refrigerator
- Recreational oven with 3-burner recessed cooktop and glass cover
- Presidential-style kitchen countertops
- Microwave
- 4 in. marine backwash
- 4 in. marine depth/driftline cushions with vinyl backing and mats (select models)
- Jayco exclusive Teddy Bear "soft-touch" residential-style front and rear cargo net in fixed bunk (bunk models only)
- Front and rear air vents
- Bath skylight and roof vent

CUSTOMER VALUE PACKAGE (MANDATORY)

- American-made 12V battery (Spartan) retail lines with self-adjusting electric brakes
- Aluminum rims
- 14 000 BTU AC
- Spare tire
- Detachable power cord
- 14 000 BTU AC
- Power awning with LED lights
- Outside shower
- Power tongue jack
- 8 gal. propane heater
- 8 gal. propane heater
- 5 gal. fresh water tank
- AWP/Bluebonnet stereo
- Rear camera
- Rear camera prep
- Inverter pre-wire

Optional Equipment

Optional Equipment	Price
Base price	44,005.00
Modern Farmhouse	N/C
USA Standards	N/C
Customer Value Package	4,875.00
Sport Package	N/C
Sea Power Package Prep	N/C
Novelty Command Control System	N/C
30 AMP Service	N/C
8 Cu. Ft. 12V Refrigerator	2382.00
20" LP Gas Bottles	N/C
Roof Ladder (Std)	N/C
Front Cap	N/C
Theater Seating w/Table	893.00

UNIT TOTAL 50,866.00

DEALER INSTALLED OPTIONS

3255.00
 54,131.00

Manufacturer's Suggested Retail Price \$50,866.00

TOTAL AMOUNT DOES NOT INCLUDE STATE AND LOCAL TAXES OR LICENSE FEES. THE PRICE SHOWN ABOVE MAY OR MAY NOT BE REPRESENTATIVE OF THE ACTUAL SELLING PRICE OF SIMILAR RECREATIONAL VEHICLES IN YOUR AREA.

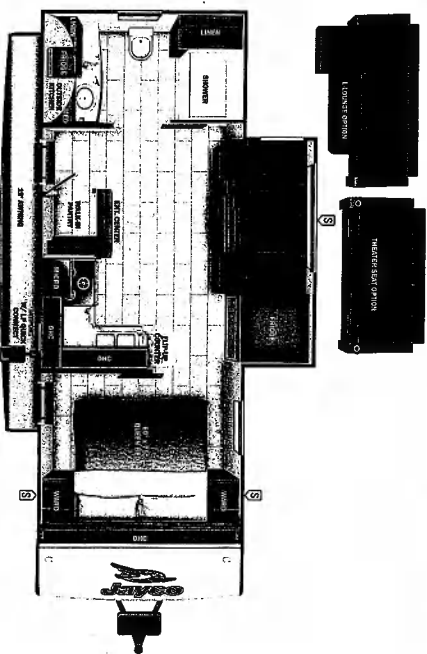

UVW 5668 lbs **Sleeps** 2-3 **Length** 27' 8.88"

DIMENSIONS

Exterior height: 128.00" Fresh water tank (gals.): 55.00
 Exterior width: 95.88" Gray water tank (gals.): 61.00

WEIGHTS

GWR: 6750 (gals.): 22.50
 GAWR (front): 3500 Propane (lbs.): 40
 GAWR (rear): 3500 Propane (gals.): 9
 Approx. Gross Cargo Carrying Capacity (GCCC): 1082 **SEATING & SLEEPING**

TIRES

Tire size (front): ST205/75R14D
 Tire size (mid): ST205/75R14D
 Tire size (rear): ST205/75R14D
 Tire size (spare): ST205/75R14D

Some dimensions may be rounded and may vary from the actual dimensions
 Weights may be estimated calculations and may vary from the actual weight
 -refer to the vehicle weight labels for actual weights***
 Floorplans, features and specifications are subject to change without notice.

