



Highland RIDGE RV

Olympia

Serial #: 58TBH0BP2N14L3070
Model: 26BHS OLYMPIA TT



Model Year: 2022 Dealer Name: RV One Superstores Gainesville
12380 NW US Hwy 441
Alachua, FL 32615
USA

Standard Equipment

- EXTERIOR**
- 120 GFCI protected receptacle
 - 5/8" main floor decking
 - 96" exterior width
 - Black front diamond plate protection
 - Detachable power cords
 - Exterior docking center (dual axle models)
 - Fiberglass insulation
 - Flexible LP lines
 - Galvanized wheel wells
 - Grab handle
 - In-frame battery rack
 - Magnetic baggage door catches
 - Magnum Roof™ system
 - Marine grade exterior speakers (2)
 - Rain gutters with molded drip spouts
 - Rear camera prep
 - Safety bumper with drain hose carrier and end caps
 - Self-adjusting electric brakes and E-Z Lube® axles
 - Thermal Seal - enclosed, insulated and heated underbelly and PVC roofing membrane with a limited lifetime warranty
 - Tinted safety-glass windows throughout
- RVR PACKAGE (MANDATORY)**
- 7-way plug and safety chain holder
 - Dinette storage doors
 - Easy lift main bed with storage below
 - Kitchen backplash
 - Pressed membrane countertops in kitchen and bathroom
 - Roller blackout night shades
 - Sofa pillows (2)
 - Solid swing-down entry step
 - Tough finish residential vinyl flooring throughout
 - TV mount/hook up
 - Upgraded baggage door frame
 - Upgraded kitchen faucet with pull-down sprayer

THE FOLLOWING ITEMS ARE STANDARD ON THIS MODEL.
A FINO EXTRA CHARGE

Optional Equipment

- INTERIOR**
- 75 lb. ball bearing drawer guides
 - 81" interior height
 - AM/FM/Bluetooth® radio with indoor/outdoor zoned speakers
 - Cable and satellite prep
 - Closable A/C vents
 - Flush floor slides with residential vinyl flooring
 - Foot flush toilet
 - Hardwood cabinet doors
 - Kid and pet friendly – residential vinyl flooring throughout, vinyl furniture
 - LED interior lighting
 - Pocket-screwed lumbercore cabinet construction
 - Range hood
 - Single basin under-mount kitchen sink
- CUSTOMER CONVENIENCE PACKAGE**
- 13,500 BTU roof mounted A/C
 - 17" oven (dual axle models)
 - 2-burner range (Sport models)
 - 3-burner range with glass cover (dual axle models)
 - Digital TV antenna
 - Gas/electric DSI water heater
 - Microwave
 - Nitrogen filled radial tires
 - Power awning with LED lighting
 - Powered bathroom vent
 - Solar prep
 - Stabilizer jacks
 - Water heater bypass

OPTIONAL EQUIPMENT INSTALLED ON THIS VEHICLE
BY MANUFACTURER

Base price	28,650.00
USA Standards	n/c
Customer Convenience Package	3,743.00
RVR Package	1,275.00
RVA	135.00
15,000 BTU AC	300.00
13,500 BTU 2nd AC Ducted	825.00
6 Cu. Ft. Gas/Electric RV Refrigerator	n/c
LED 32" TV	893.00
Manual Stab Jacks	n/c

UNIT TOTAL

35,821.00

DEALER INSTALLED OPTIONS

Manufacturer's Suggested Retail Price

\$35,821.00

+1560 = 37,381

TOYOTA/MINI DOES NOT INCLUDE STATE AND LOCAL TAXES OR LICENSE FEES. THESE PRICES SHOW MARKET VALUE ONLY AND BE REPRESENTATIVE OF THE ACTUAL SELLING PRICE OF SIMILAR RECREATIONAL VEHICLES IN YOUR AREA.

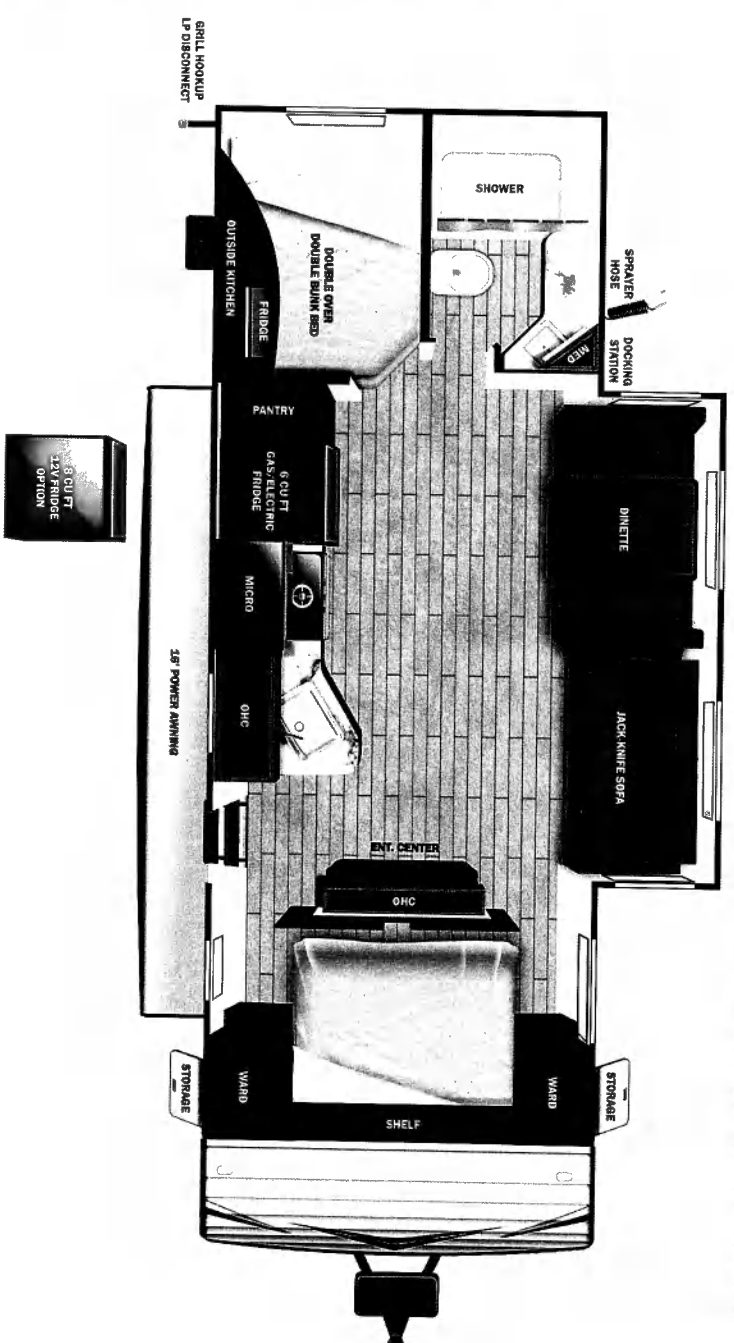

UWV
5959 lbs

Sleeps

Length
30' 8.88"

DIMENSIONS

Exterior height:.....132.38" Fresh water tank (gals.):...42.00
Exterior width:.....96.00" Gray water tank (gals.):...32.50

WEIGHTS

GVWR:.....7500 Black water/toilet tank (gals.):.....32.50
GAWR (Front) :.....3500 Propane (lbs.):.....60
GAWR (rear) :.....3500 Propane (gals.):.....14
Approx. Gross Cargo Carrying Capacity(GCCC):.....1541 Water heater (gals.):.....6.00

TIRES

Tire size (front):.....ST205/75R15D
Tire size (mid):.....
Tire size (rear):.....ST205/75R15D

SEATING & SLEEPING

Some dimensions may be rounded and may vary from the actual dimensions
***Weights may be estimated calculations and may vary from the actual weight
- refer to the vehicle weight labels for actual weights***
Floorplans, features and specifications are subject to change without notice.



110-746474