

Seismic Luxury Series

Serial #: 1UJCGSBV4P19U0089  
Model: 3512 SEISMIC LUXURY SERIES FW



Model Year: 2023 Dealer Name: RV ONE SUPERSTORES-ST. AUGUSTINE  
6775 US 1 SOUTH  
ST. AUGUSTINE, FL 32086  
USA



Standard Equipment

THE FOLLOWING ITEMS ARE STANDARD ON THIS MODEL  
AT NO EXTRA CHARGE

Optional Equipment

OPTIONAL EQUIPMENT INSTALLED ON THIS VEHICLE  
BY MANUFACTURER

- EXTERIOR
- 102 in. wide-body structural steel I-beam construction
  - Stronghold VBI™ aluminum framed and vacuum bond laminated gelcoated fiberglass exterior walls (including slide room end walls)
  - Magnum Truss™ (strongest tested roof in the industry) with one piece, seamless roof material with 20 year warranty
  - Climate Shield™ zero-degree tested weather protection.
  - Fully enclosed and heated underbelly (ducted)
  - 40,000 BTU output furnace
  - Double layer fiberglass batt insulation (roof and floor)
  - PEX plumbing
  - Helix Cooling System™ (industry exclusive):
    - Two exterior-mounted 15,000 BTU "Whisper Quiet" A/C unit (living room and bedroom)
    - Jayco exclusive insulated dual duct design
    - Directional and closable A/C vents
    - Larger return air vents with user-accessible filters
    - JaySMART™ (Safety Markers And Reverse Travel) LED lighting (patent-pending)
    - Painted fiberglass front cap with double clear coat and built-in specially LED lighting
    - Custom automotive-grade vinyl exterior graphics package
    - LED exterior lighting package
    - Detachable shore power cord
    - Dual 30 lb. propane bottle with auto regulator
    - Pass-through storage with Slam-Iatch™ baggage doors
    - Digital TV antenna with Wi-Fi extender
    - Exterior marine-grade speakers
    - Fully enclosed LED-ill universal docking center:
    - Quick-connect outside shower
    - Black tank flush
    - Winterization and sanitation
    - Independent satellite wiring
    - Whole coach cable hookups
    - Water heater bypass
    - Battery disconnect
    - Under-mounted spare tire (17.5 in. Uniroyal H rated tire)
    - Folding roof ladder
    - DayPort for outside griddle
    - Oversized multi-battery compartment (industry leading room for 4-6 batteries)
    - 3-season removable garage wall
    - RAMP AND CARGO EQUIPMENT
      - Rear ramp door and patio with anti-slip, non-skid flooring
      - LED high-intensity ramp lights
      - Tuff-ply, rubberized garage floor liner
      - 2 in. block-foam fully insulated garage floor (industry first)
      - Garage D-rings mounted to steel frame
      - Ram air vents and power roof vent
      - HappiJac® electric-lift queen beds/convenient sofas with folding armrests and cup holders
      - Three seasons garage wall/doors (removable)
      - Dual 30 gal. fuel tanks with timer (1 dedicated to generator)
      - Ramp patio kit with exterior steps
      - Rear patio awning
  - 5 STAR HANDLING PACKAGE (MANDATORY)
    - 17.5 in. Uniroyal H rated tires
    - Dexter® axles with New-R-Adjust® brakes, E-Z Lube® hubs, & 4000 lb. leaf springs
    - MORryde® pin box
    - MORryde® CRH-3000™ rubberized suspension
    - Wet bolt fasteners and bronze bushings

INTERIOR

Base price	144,818.00
Modern Farmhouse	n/c
Graphics	n/c
USA Standards	n/c
Customer Value Package w/15,000 BTU AC & Heat Pump	10,950.00
Five Star Handling Package	n/c
No Overlander Package	n/c
15,000 AC Drop in Cargo	893.00
21 Cu. Ft. Residential Refrigerator	593.00
No Cargo TV	n/c
Gas/Electric DSI Water Heater	n/c
Pre-Wired Sanicon Dump System	n/c
Backup, Side and Entry Door Observation Camera Prep	n/c
Tinted Safety Glass	n/c
Windows	n/c
Electronic Drum Brakes	n/c
King Bed	n/c

UNIT TOTAL

157,254.00

DEALER INSTALLED OPTIONS

Manufacturer's Suggested Retail Price \$157,254.00

TOTAL AMOUNT DOES NOT INCLUDE STATE AND LOCAL TAXES OR LICENSE FEES. THE PRICE SHOWN ABOVE MAY OR MAY NOT BE REPRESENTATIVE OF THE ACTUAL SELLING PRICE OF SIMILAR RECREATIONAL VEHICLES IN YOUR AREA.

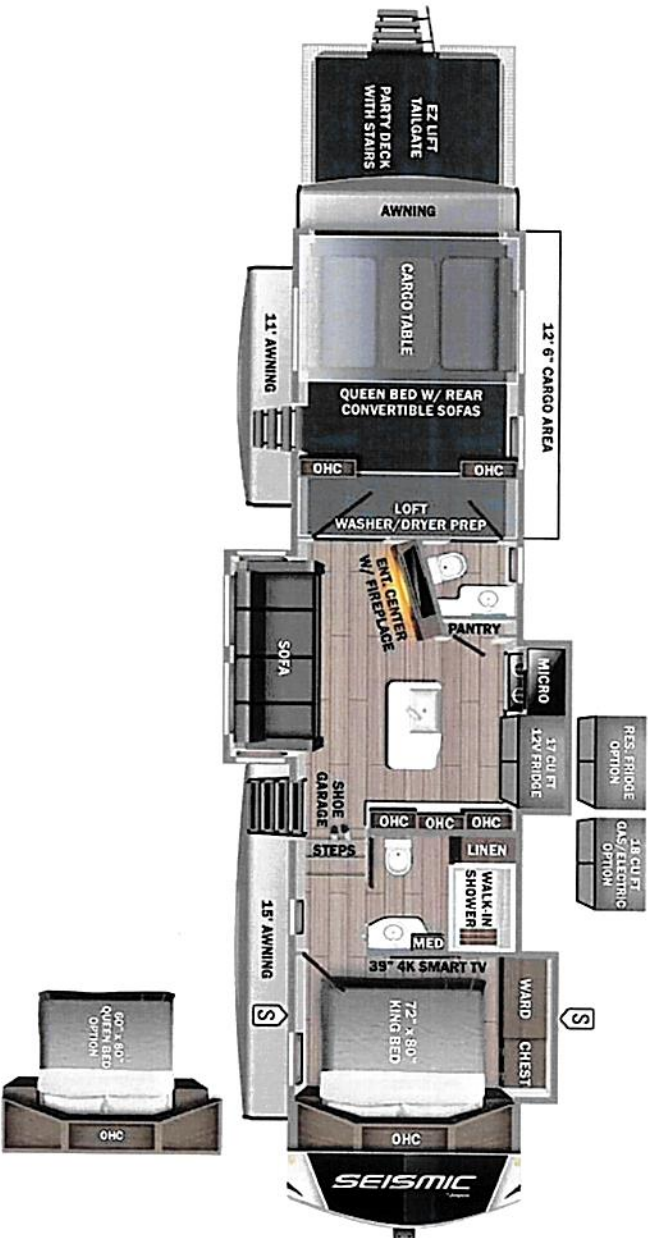

UVW 14721 lbs

Sleeps

Length 41' 9.5"

DIMENSIONS

Exterior height:	158.25"	CAPACITIES	Fresh water tank (gals.):	106.10
Exterior width:	102.00"		Gray water tank (gals.):	87.00

WEIGHTS

GVWR:	17500		Black water/toilet tank (gals.):	87.00
GAWR (front):	8000		Propane (lbs.):	60
GAWR (rear):	8000		Propane (gals.):	14
Approx. Gross Cargo Carrying Capacity(GCCC):	2779		Water heater (gals.):	16.00

SEATING & SLEEPING

TIRES

Tire size (front):	215/75R17.5H
Tire size (mid):	
Tire size (rear):	215/75R17.5H
Tire size (spare):	215/75R17.5H

\*\*\*Some dimensions may be rounded and may vary from the actual dimensions\*\*\*  
\*\*\*Weights may be estimated calculations and may vary from the actual weight  
- refer to the vehicle weight labels for actual weights\*\*\*  
Floorplans, features and specifications are subject to change without notice.

