

109- M6530

Redhawk



Jayco®



Serial #: 1UJLCBN1P1XD4117  
Model: 26XD REDHAWK MHC  
VIN#: 1FDXE4FNXPDD33184  
Model Year: 2023 Dealer Name: RV ONE SUPERSTORES-ST. AUGUSTINE

6775 US 1 SOUTH  
ST. AUGUSTINE, FL 32086  
USA

Standard Equipment

Optional Equipment

THE FOLLOWING ITEMS ARE STANDARD ON THIS MODEL  
AT NO EXTRA CHARGE

OPTIONAL EQUIPMENT INSTALLED ON THIS VEHICLE  
BY MANUFACTURER

- STANDARD EXTERIOR EQUIPMENT
- Ford® E-450 chassis
  - GVWR- 14,500 lb.
  - GCWR- 22,000 lb.
  - 7.3L V-8 350 HP engine with 468 ft.-lb. torque
  - 6-speed TorqShift® series transmission with overdrive
  - 210 amp alternator
  - E-rated highway tires- LT225/75R16
  - Tire pressure monitoring system (TPMS)
  - Power anti-lock brakes with power steering
  - 7,500 lb. hitch with 750 lb. tongue capacity and 7-pin plug
  - 12V chassis battery
  - 55 gal. fuel tank
  - StrongholdVBL™ roof, floor and sidewalls
  - Bead-foam insulation (R-24 max roof, R-9 max floor, R-5 max walls)
  - TPO laminated roof
  - Aluminum running boards
  - Fiberglass exterior walls with vinyl graphics
  - Leveling jack prep
  - Frameless windows
  - Remote keyless cab entry
  - Entrance door with industry's largest travel-view window
  - Electric-powered entrance step with integrated house battery compartment
  - 12V house battery
  - (2) high-output, marine-grade exterior speakers
  - Slideout awning(s)
  - Pass-through storage compartment with light (select models)
  - 12.2 gal. propane tank (41 lb.)
  - LP quick-connect hookup
  - Exterior utility center
  - Winterization drain system
  - Outside shower
  - 12V demand water pump
  - 4,000W generator
  - Transfer switch with reverse polarity protection
  - 30 amp electrical service
  - Solar prep
  - Third brake light
  - Roof ladder
  - 4 in. bumper tube sewer hose storage
- STANDARD INTERIOR EQUIPMENT
- Remote-controlled, side-view mirrors
  - Swivel driver and passenger seats (N/A 26M, 29XK)
  - Driver and passenger airbags
  - Power windows and door locks
  - Tilt steering wheel
  - A/C and cruise control
  - Auxiliary start switch
  - Privacy curtains for cab area
  - 84 in. ceiling height
  - High-intensity, recessed LED ceiling lights
  - LED-ill slideout fascia
  - Hardwood cabinet doors and drawers
  - Ball-bearing drawer guides
  - Jayco-exclusive, easy-operation legless dinette table
  - 2-point lap safety belts in all designated seating locations
  - Interior entrance door grab handle
  - Interior command center
  - Pleated blackout shades
  - 15,000 BTU ducted A/C
  - 30,000 BTU auto-ignition furnace
  - Electric fireplace (26M)
  - 6 gal. gas/electric DSI auto-ignition water heater
  - Frameless windows
  - Prep for satellite dish
  - Cable TV hookup with RG-6 coax
  - Digital antenna with signal booster
  - Furrion® all-in-one cooktop and oven
  - Residential-size microwave
  - Stainless steel kitchen sink
  - Decorative kitchen backsplash
  - Pop-up charging station with 110V outlet and USB plugs
  - LED-ill pressed countertops
  - Water filtration system
  - Shower with decorative ABS surround and skylight
  - Stainless steel bathroom sink
  - Toilet with foot flush
  - Vent fan in bathroom
  - Queen-size bed with bedspread
  - USB port and wireless charging in nightstands (26XD, 29XK, 31F)
  - USB port in cabinet over bed (24B, 26M)
  - Under-bed storage (select models)
  - Large wardrobes
  - Overhead bunk with 750 lb. capacity and safety net
  - Bunks with industry-exclusive 300 lb. capacity each (31F)
  - Smoke alarm
  - Carbon monoxide detector

- CUSTOMER VALUE PACKAGE
- JHIDE®: Computer-balanced driveshaft, standard front and rear stabilizer bars, Hellwig® helper springs, rubber isolation body mounts
  - One-piece, seamless, fiberglass front cap
  - Heated holding tanks (12V pads)
  - Electric patio awning with LED lights
  - Black holding tank sprayer
  - Sony® infotainment center with Apple® CarPlay™ and Android Auto™
  - Backup and side-view cameras
  - LED HD Smart TV in living area

UNIT TOTAL 152,229.00

DEALER INSTALLED OPTIONS

Manufacturer's Suggested Retail Price \$152,229.00

TOTAL AMOUNT DOES NOT INCLUDE STATE AND LOCAL TAXES OR LICENSE FEES. THE PRICE SHOWN ABOVE MAY OR MAY NOT BE REPRESENTATIVE OF THE ACTUAL SELLING PRICE OF SIMILAR RECREATIONAL VEHICLES IN YOUR AREA.

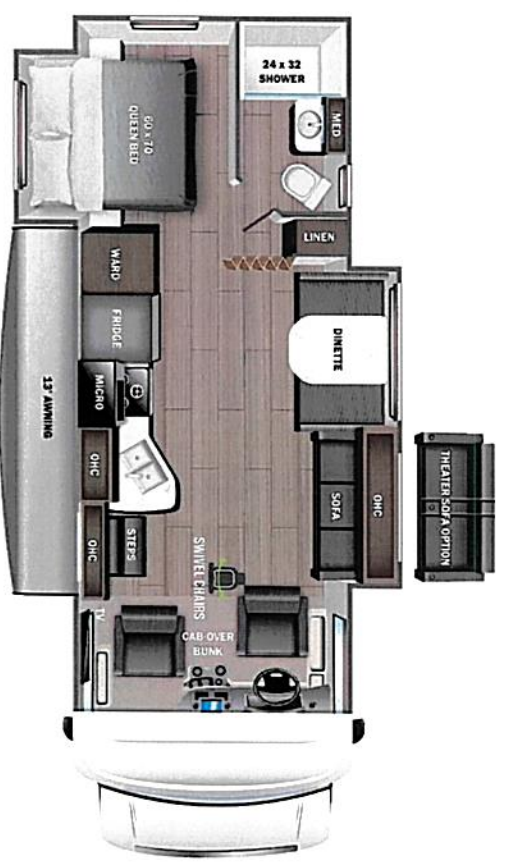

DIMENSIONS

Exterior height:.....138.00"  
Exterior width:.....100.00"

CAPACITIES

Fresh water tank (gals.):...43.50  
Gray water tank (gals.):...41.00  
Black water/toilet tank (gals.):...32.00  
Propane (lbs.):...41  
Propane (gals.):...9  
Water heater (gals.):...6.00

TIRES

Tire size (front):.....LT225/75R16E  
Tire size (mid):.....  
Tire size (rear):.....LT225/75R16E

\*\*\*Some dimensions may be rounded and may vary from the actual dimensions\*\*\*  
\*\*\*Weights may be estimated calculations and may vary from the actual weight\*\*\*  
- refer to the vehicle weight labels for actual weights\*\*\*  
Floorplans, features and specifications are subject to change without notice.

