

109-M 274578

Redhawk



Serial #: 1UJLJCBR0N1XK4151
 Model: 29XK REDHAWK MHC
 VIN#: 1FDXE4FN6PDD15748
 Model Year: 2022 Dealer Name: RV ONE SUPERSTORES-ST. AUGUSTINE
 6775 US 1 SOUTH
 ST. AUGUSTINE, FL 32086
 USA

Standard Equipment

THE FOLLOWING ITEMS ARE STANDARD ON THIS MODEL AT NO EXTRA CHARGE

- EXTERIOR**
- Ford® E-450 chassis
 - GVWR- 14,500 lb.
 - GCWR- 22,000 lb.
 - 7.3L V-8 350 HP engine with 468 ft.-lb. torque
 - 6-speed TorqShift® series transmission with overdrive
 - 210-amp alternator
 - E-rated highway tires- LT225/75R16
 - Tire pressure monitoring system (TPMS)
 - Power anti-lock brakes with power steering
 - 7,500 lb. hitch with 750 lb. tongue capacity and 7-pin plug
 - 12V chassis battery
 - 55 gal. fuel tank
 - Remote-controlled, side-view mirrors
 - StrongholdVBL™ roof, floor and sidewalls
 - Bead-lean insulation (R-24 max roof, R-9 max floor, R-5 max walls)
 - FPO laminated roof
 - Aluminum running boards
 - Fiberglass exterior walls with vinyl graphics
 - Leveling jack prep
 - Flameless windows
 - Remote keyless cab entry
 - Entrance door with industry's largest travel-view window
 - Electric-powered entrance step with integrated house battery compartment
 - 12V house battery
 - (2) high-output, marine-grade exterior speakers
 - Slideout cover awnings
 - Pass-through storage compartment with light (select models)
 - 12.2 gal. propane tank (41 lb.)
 - LP quick-connect hookup
 - Exterior utility center
 - Winterization drain system
 - Outside shower
 - 12V demand water pump
 - Onan® 4,000-watt MicroQuiet™ generator with auto-changeover
 - Transfer switch with reverse polarity protection
 - 30-amp electrical service
 - Solar prep
 - Third brake light
 - Roof ladder
 - 4 in. bumper lube sewer hose storage

Optional Equipment

OPTIONAL EQUIPMENT INSTALLED ON THIS VEHICLE BY MANUFACTURER

- INTERIOR**
- Swivel driver and passenger seats (N/A 25R)
 - Driver and passenger airbags
 - Power windows and door locks
 - Tilt steering wheel
 - A/C and cruise control
 - Auxiliary start switch
 - Privacy curtains for cab area
 - 84 in. ceiling height
 - High-intensity, recessed LED ceiling lights
 - LED-ill slideout fascia
 - Hardwood cabinet doors and drawers
 - Ball-bearing drawer guides
 - Jayco-exclusive, easy-operation legless dinette table
 - 2-point lap safety belts in all designated seating locations
 - Interior entrance door grab handle
 - Interior command center
 - Pleated blackout shades
 - 15,000 BTU ducted A/C
 - 31,000 BTU auto-ignition furnace
 - 6 gal. gas/electric DSI auto-ignition water heater
 - Prep for satellite dish
 - Cable TV hookup with RG-6 coax
 - Digital antenna with signal booster
 - Furrion® all-in-one cooktop and oven
 - Residential-size microwave
 - Stainless steel kitchen sink
 - Decorative kitchen backsplash
 - Pop-up charging station with 110 outlet and USB plugs
 - LED-ill, pressed countertops
 - Water filtration system
 - Shower with decorative ABS surround and skylight
 - Stainless steel bathroom sink
 - Toilet with foot flush
 - Vent fan in bathroom
 - Queen-size bed with bedspread
 - Under-bed storage (select models)
 - Large wardrobes
 - Overhead bunk with 750 lb. capacity and safety net
 - Bunks with industry-exclusive 300 lb. capacity each (31F)
 - Smoke alarm
 - Carbon monoxide detector

Base price	140,055.00
Modern Farmhouse	443.00
USA Standards	N/C
Customer Value Package	6,000.00
Dual A/Cs	1,193.00
4.0 KW Onan Generator	N/C
No Solar Panel	N/C
Standard House Battery	N/C
Sofa	N/C

- CUSTOMER VALUE PACKAGE**
- JRIDED® Computer-balanced driveshaft, standard front and rear stabilizer bars, Helwig® helper springs, rubber isolation body mounts
 - One-piece, seamless, fiberglass front cap
 - Heated holding tanks (12V Pads)
 - Electric patio awning with LED lights
 - Black holding tank sprayer
 - Sony® infotainment center with Apple® CarPlay™ and Android Auto™
 - Backup and side-view cameras
 - LED HD Smart Fire TV in living area
 - 8 cu. ft. flush-mount, double-door refrigerator

UNIT TOTAL

147,691.00

DEALER INSTALLED OPTIONS

Manufacturer's Suggested Retail Price \$147,691.00

TOTAL AMOUNT DOES NOT INCLUDE STATE AND LOCAL TAXES OR LICENSE FEES. THE PRICE SHOWN ABOVE MAY OR MAY NOT BE REPRESENTATIVE OF THE ACTUAL SELLING PRICE OF SIMILAR RECREATIONAL VEHICLES IN YOUR AREA.

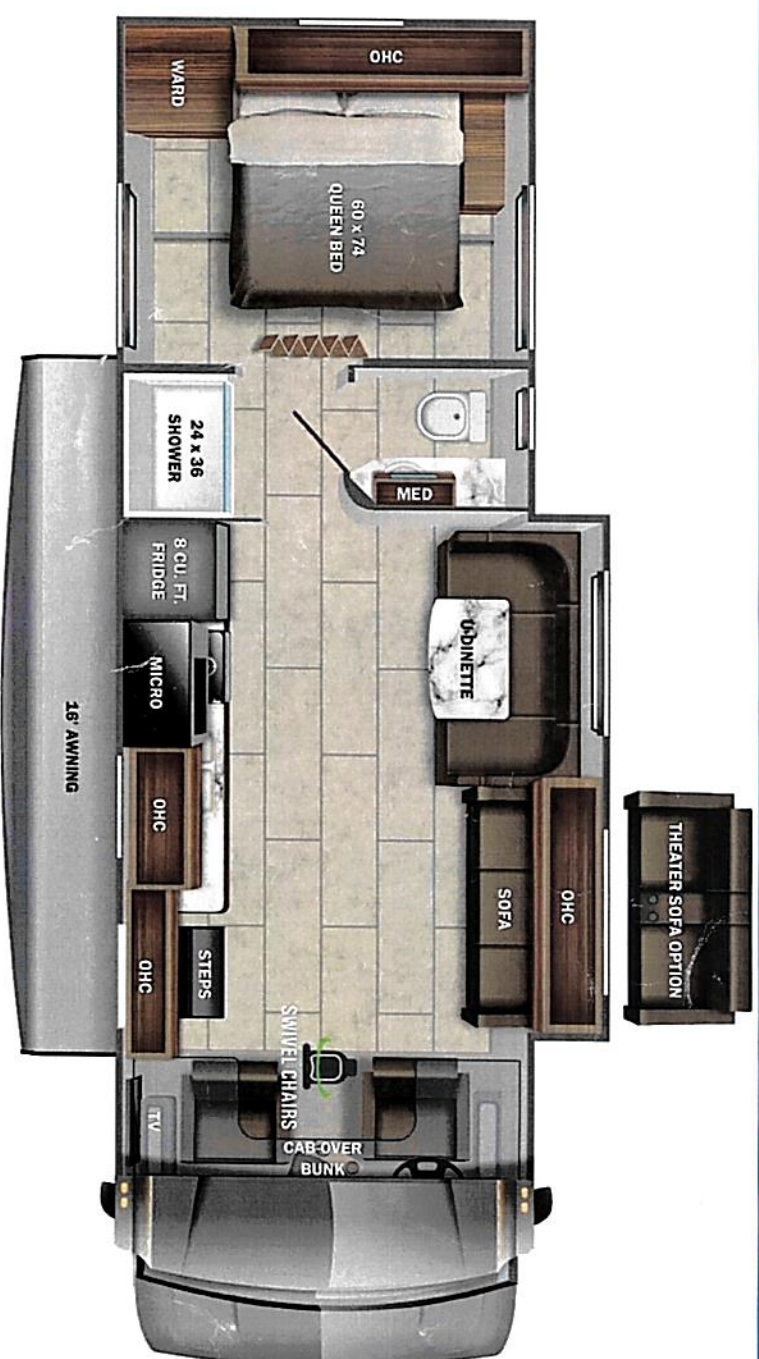

DIMENSIONS

Exterior height:.....138.00"
 Exterior width:.....100.00"

CAPACITIES

Fresh water tank (gals.):...43.50
 Gray water tank (gals.):...41.00
 Black water/toilet tank (gals):...32.00
 Propane (lbs.):...41
 Propane (gals.):...9
 Water heater (gals.):...6.00

TIRES

Tire size (front):.....LT225/75R16E
 Tire size (mid):.....
 Tire size (rear):.....LT225/75R16E

Some dimensions may be rounded and may vary from the actual dimensions
 Weights may be estimated calculations and may vary from the actual weight - refer to the vehicle weight labels for actual weights
 Floorplans, features and specifications are subject to change without notice.

