



Highland RIDGE RV

Olympia

Serial #: 58TBH0BP9N14L3308
Model: 26BHS OLYMPIA TT

Model Year: 2022 Dealer Name: RV ONE SUPERSTORES-ST. AUGUSTINE
6775 US 1 SOUTH
ST. AUGUSTINE, FL 32086
USA



Standard Equipment

THE FOLLOWING ITEMS ARE STANDARD ON THIS MODEL
AT NO EXTRA CHARGE

- EXTERIOR**
- 120 GFCI protected receptacle
 - 5/8" main floor decking
 - 96" exterior width
 - Black front diamond plate protection
 - Detachable power cords
 - Exterior docking center (dual axle models)
 - Fiberglass insulation
 - Flexible LP lines
 - Galvanized wheel wells
 - Grab handle
 - In-frame battery rack
 - Magnetic baggage door catches
 - Magnum Roof™ system
 - Marine grade exterior speakers (2)
 - Rain gutters with molded drip spouts
 - Rear camera prep
 - Safety bumper with drain hose carrier and end caps
 - Self-adjusting electric brakes and E-Z Lube® axles
 - Thermal Seal - enclosed, insulated and heated underbelly and PVC roofing membrane with a limited lifetime warranty
 - Tinted safety-glass windows throughout
- RVR PACKAGE (MANDATORY)**
- 7-way plug and safety chain holder
 - Baggage door frame with hinge cover and magnetic catch
 - Dinette storage doors
 - Easy lift main bed with storage below
 - Kitchen backslash
 - Pressed membrane countertops in kitchen and bathroom
 - Residential kitchen faucet with pull-down sprayer
 - Roller blackout night shades
 - Sofa pillows (2)
 - Solid swing-down entry step
 - Tough finish residential vinyl flooring throughout
 - TV mount/hook up

Optional Equipment

OPTIONAL EQUIPMENT INSTALLED ON THIS VEHICLE
BY MANUFACTURER

- INTERIOR**
- 75 lb. ball bearing drawer guides
 - 81" interior height
 - AM/FM/Dualtech® radio with indoor/outdoor zoned speakers
 - Cable and satellite prep
 - Cosable A/C vents
 - Flush floor slides with residential vinyl flooring
 - Foot flush toilet
 - Hardwood cabinet doors
 - Kid and pet friendly - residential vinyl flooring throughout, vinyl furniture
 - LED interior lighting
 - Pocket-screwed lumbercore cabinet construction
 - Range hood
 - Single basin under-mount kitchen sink
- CUSTOMER CONVENIENCE PACKAGE**
- 13,500 BTU roof mounted A/C
 - 17" oven (dual axle models)
 - 2-burner range (Sport models)
 - 3-burner range with glass cover (dual axle models)
 - Digital TV antenna
 - Gas/electric DSI water heater
 - Microwave
 - Nitrogen filled radial tires
 - Power awning with LED lighting
 - Powered bathroom vent
 - Solar prep
 - Stabilizer jacks
 - Water heater bypass

Base price	29,025.00
USA Standards	n/c
Customer Convenience Package	3,743.00
RVR Package	1,275.00
Solar Power Package	525.00
FVIA	135.00
15,000 BTU AC	300.00
13,500 BTU 2nd AC Ducted	825.00
6 Cu. Ft. Gas/Electric RV Refrigerator	n/c
LED 32" TV	893.00
Manual Stab Jacks	n/c

UNIT TOTAL **36,721.00**

DEALER INSTALLED OPTIONS

Manufacturer's Suggested Retail Price \$36,721.00

TOTAL AMOUNT DOES NOT INCLUDE STATE AND LOCAL TAXES OR LICENSE FEES. THE PRICE SHOWN ABOVE MAY OR MAY NOT BE REPRESENTATIVE OF THE ACTUAL SELLING PRICE OF SIMILAR RECREATIONAL VEHICLES IN YOUR AREA.

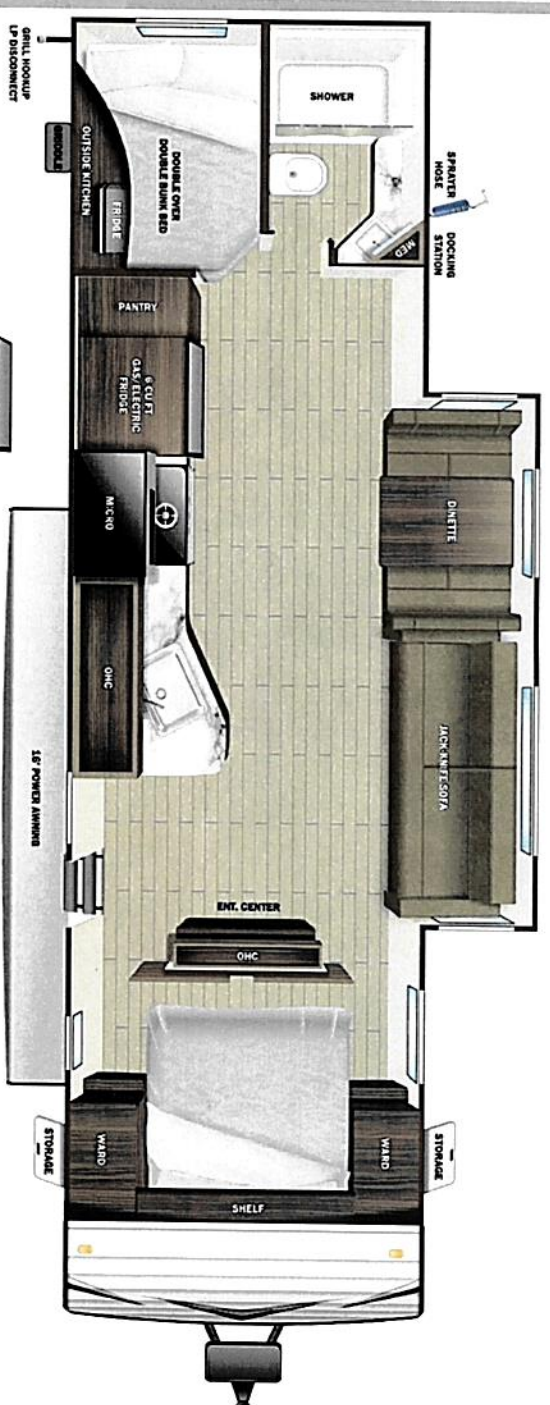

UWW 5974 lbs
Sleeps 30' 8.88"

- DIMENSIONS**
- Exterior height: 132.38"
 - Exterior width: 96.00"
- WEIGHTS**
- GVWR: 7500
 - GAWR (front): 3500
 - GAWR (rear): 3500
 - Approx. Gross Cargo Carrying Capacity (GCCC): 1526
- TIRES**
- Tire size (front): ST205/75R15D
 - Tire size (mid):
 - Tire size (rear): ST205/75R15D
- CAPACITIES**
- Fresh water tank (gals.): 42.00
 - Gray water tank (gals.): 32.50
 - Black water/toilet tank (gals.): 32.50
 - Propane (lbs.): 60
 - Propane (gals.): 14
 - Water heater (gals.): 6.00
- SEATING & SLEEPING**

Some dimensions may be rounded and may vary from the actual dimensions
Weights may be estimated calculations and may vary from the actual weight
- refer to the vehicle weight labels for actual weights ***
Floorplans, features and specifications are subject to change without notice.



109-150533