

Jay Feather



Serial #: 1UJBUBM6M1J40138
Model: 22RB JAY FEATHER TT

Model Year: 2021 Dealer Name: RV One Superstores Ft. Myers

16065 S. Tamiami Trail
Fort Myers, FL 33908
USA

T18349

Manufacturer's Suggested Retail Price \$36,743.00

TOTAL AMOUNT DOES NOT INCLUDE STATE AND LOCAL TAXES OR LICENSE FEES. THE PRICE SHOWN ABOVE MAY OR MAY NOT BE REPRESENTATIVE OF THE ACTUAL SELLING PRICE OF SIMILAR RECREATIONAL VEHICLES IN YOUR AREA.

Standard Equipment

THE FOLLOWING ITEMS ARE STANDARD ON THIS MODEL AT NO EXTRA CHARGE

- Exterior**
- Aerodynamic, rounded front profile with diamond plate
 - Modern retro graphics package with two-colored sidewall
 - Stronghold VBL™ vacuum-bonded, laminated floor, side, rear and slide room walls
 - Keyed Alike™ lock system
 - Magnum Truss™ Roof System with one-piece seamless DFlex II material
 - American-made Norco® frame with integrated A-frame
 - Dual axles
 - G20 tinted safety-glass windows
 - Marine-grade exterior speakers with blue LED accent lighting (2)
 - American-made Dexter EZ Lube® axles
 - Galvanized steel and impact-resistant wheel wells
 - Slideouts with double seals, barrier sponges and U-channel drip spout (select models)
 - 30 amp service
 - Outside grill propane quick-connect port
 - Rear camera backup prep
 - Folding assist handle on main entry doors
 - Aluminum tread entry steps
 - Outside camp kitchen (standard on select models)
 - Battery quick disconnect
 - Slide topper prep (select models with slide rooms)
 - Inverter pre wire
 - Exterior TV prep with 120V electric and cable outlets

Optional Equipment

OPTIONAL EQUIPMENT INSTALLED ON THIS VEHICLE BY MANUFACTURER

- Interior**
- Choice of two interior design packages - Modern Farmhouse White or Vintage Wash Grey
 - Screwed and glued cabinetry
 - Smoked glass decorative inserts (select overhead cabinets)
 - Ball-bearing drawer glides with 75 lb. capacity
 - LED lighting throughout
 - 6 cu. ft. gas/electric refrigerator
 - Residential oven with 3-burner recessed cooktop and glass cover
 - Residential-style kitchen countertops
 - Residential vinyl flooring with cold crack resistance
 - Microwave
 - Plywood dinette, bunk and bed bases (applicable models)
 - 4 in. high-density dinette cushions with vinyl backing
 - Foam mattress with bedspread (select models)
 - Jayco exclusive 'Buddy Bear' soft-touch residential-style bed mats
 - 120V outlet and corner shelf in fixed bunks (bunk models only)
 - Plastic foot flush toilet
 - Decorative wall clock (select models)
 - Decorative backplash

- Base price 31,868.00
- Vintage Washed Grey n/c
- USA Standards n/c
- Customer Value Package 4,875.00
- Sport Package n/c
- No.JayCommand Control System n/c
- 13,500 BTU AC Roof Mounted n/c
- 30 AMP Service n/c
- 6 Cu. Ft. Gas/Electric Refrigerator n/c
- 20# LP Gas Bottles n/c
- U-Dinette n/c

- CUSTOMER VALUE PACKAGE (MANDATORY)**
- American-made nitro-filled Goodyear® radial tires with self-adjusting brakes
 - Aluminum rims
 - 20 lb. propane bottles with auto regulator (2)
 - 13,500 BTU A/C
 - Spare tire
 - Detachable power cord
 - Power awning with LED lights
 - Black tank flush
 - Outside shower
 - Power tongue jack
 - 6 gal. gas/electric DSI water heater
 - AM/FM/Bluetooth® stereo
 - Enclosed underbelly
 - Furrion® side-marker camera prep
 - Furrion® rear camera backup prep
 - 360 Siphon®
 - Manual stabilizer jacks (4)

- SPORT PACKAGE (MANDATORY)**
- 24 in., 32 in. or 40 in. LED TV
 - Aluminum tread entry steps
 - Drying rack/ sink cover
 - Enhanced graphics package
 - Front molded fiberglass cap
 - JaySMART™ (Safety Markers And Reverse Travel) LED lighting (patent-pending)
 - Roof ladder
 - Roof-mount solar prep
 - Glacier Package
 - Fan-Tastic Vent power roof vent (main living area)

UNIT TOTAL

36,743.00

DEALER INSTALLED OPTIONS

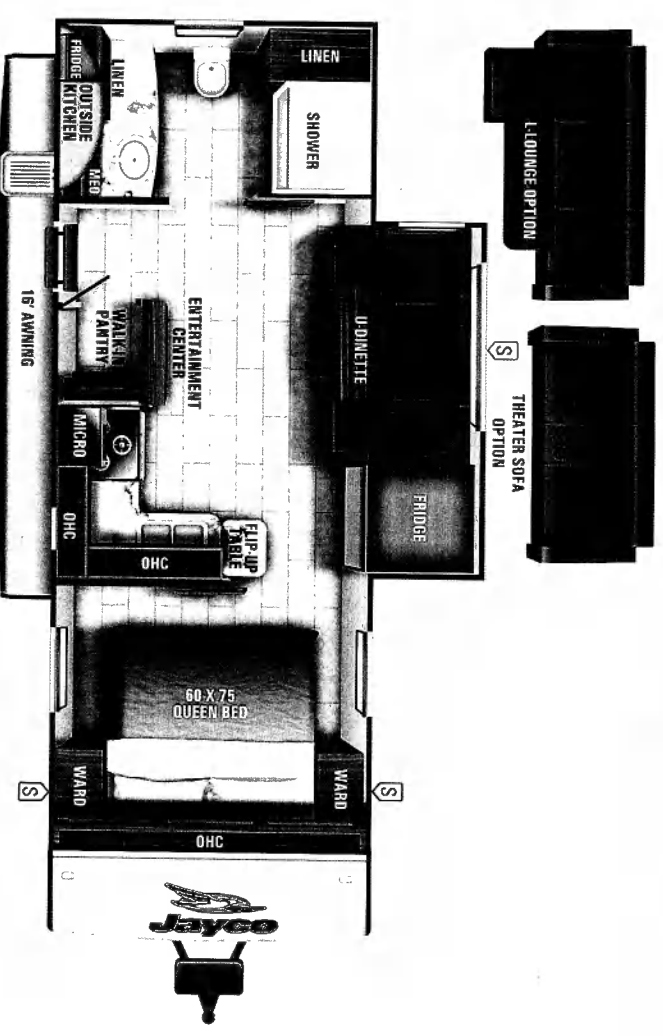

UWV
5690 lbs



Sleeps
2-3



Length
27' 8.88"

DIMENSIONS

Exterior height:.....128.00" Fresh water tank (gals.):...42.00
Exterior width:.....96.00" Gray water tank (gals.):...61.00

WEIGHTS

GVWR:.....6750 (gals):.....22.50
GAWR (front) :.....3500 Propane (lbs.):.....40
GAWR (rear) :.....3500 Propane (gals.):.....9
Approx. Gross Cargo Carrying Capacity(GCCC):.....1060 Water heater (gals.):.....6.00

SEATING & SLEEPING

Queen bed:.....60 X 75
U-Dinette standard:.....40 X 82
Sofa L-Lounge option:.....40 X 78
Theater option:.....60

TIRES

Tire size (front) :.....ST205/75R14D
Tire size (mid) :.....
Tire size (rear) :.....ST205/75R14D
Tire size (spare) :.....ST205/75R14D

Some dimensions may be rounded and may vary from the actual dimensions
***Weights may be estimated calculations and may vary from the actual weight
- refer to the vehicle weight labels for actual weights***
Floorplans, features and specifications are subject to change without notice.

