

MT77459

Redhawk



Serial #: 1UJLJCBN6R1XM4102
 Model: 26M REDHAWK MHC
 VIN#: 1FDXE4FN4RDD39050
 Model Year: 2024 Dealer Name: RV ONE SUPERSTORES TAMPA
 4656 MCINTOSH ROAD
 DOVER, FL 33527
 USA

Standard Equipment

THE FOLLOWING ITEMS ARE STANDARD ON THIS MODEL AT NO EXTRA CHARGE

- STANDARD EXTERIOR EQUIPMENT**
- Ford® E-450 Chassis
 - GVWR- 14,500 lb.
 - GCWR- 22,000 lb.
 - 7.3L V-8 325 HP engine with 450 ft.-lb. torque
 - 6-speed TorqShift® series transmission with overdrive
 - 210-amp alternator
 - Catalytic converter theft deterrent
 - E-rated highway tires- L1725/75R16
 - Tire pressure monitoring system (TPMS)
 - Power anti-lock brakes with power steering
 - 7,500 lb. hitch with 750 lb. tongue capacity and 7-pin plug
 - 12V chassis battery
 - 55 gal. fuel tank
 - Swivel driver and passenger seats (24B, 26XD, 31F)
 - Remote-controlled, side-view mirrors
 - Stronghold™ roof, floor and sidewalls
 - Bead-beam insulation (R-24 max roof, R-9 max floor, R-5 max walls)
 - TPO laminated roof
 - Aluminum running boards
 - Fiberglass exterior walls with vinyl graphics
 - Leveling jack prep
 - Frameless windows
 - Remote keyless cab entry
 - Entrance door with industry's largest travel-view window
 - Electric-powered entrance step with integrated house battery compartment
 - (2) high-output, marine-grade exterior speakers
 - Slideout awning(s)
 - Pass-through storage compartment with light (select models)
 - Third brake light
 - Roof ladder
 - 4 in. bumper tube sewer hose storage
 - Prep for satellite dish
 - Cable TV hookup with RG-6 coax
 - Digital antenna with signal booster
 - 4,000W generator
 - Solar prep
 - 12V house battery
 - Transfer switch with reverse polarity protection
 - 30-amp electrical service
 - 12.2 gal. propane tank (41 lb.)
 - LP quick-connect hookup
 - Exterior utility center
 - Winimization drain system
 - Outside shower
 - 12V demand water pump
 - Water filtration system

- CUSTOMER VALUE PACKAGE**
- JHIDE® Computer-balanced driveshaft, standard front and rear stabilizer bars, Hellwig® helper springs, rubber isolation body mounts
 - One-piece, seamless, fiberglass front cap with power shade
 - Automotive-bonded, panoramic window in front cap
 - Heated holding tanks (12V pads)
 - Electric patio awning with LED lights
 - Black holding tank sprayer
 - Sony® in-entertainment center with Apple® CarPlay™ and Android Auto™
 - Backup and side-view cameras
 - LED HD Smart TV in living area

Optional Equipment

OPTIONAL EQUIPMENT INSTALLED ON THIS VEHICLE BY MANUFACTURER

- STANDARD INTERIOR EQUIPMENT**
- Tilt steering wheel
 - Cruise control
 - Hill start assist
 - Electronic stability control
 - Traction control
 - Auxiliary start switch
 - Power windows and door locks
 - Driver and passenger airbags
 - Privacy curtain for cab area
 - Overhead bunk with 750 lb. capacity and safety net
 - 84 in. ceiling height
 - High-intensity, recessed LED ceiling lights
 - LED-ill. slideout fascia
 - Hardwood cabinet doors and drawer fronts
 - Ball-bearing drawer guides
 - Interior entrance door grab handle
 - Interior command center
 - Pleated blackout shades
 - 15,000 BTU ducted A/C
 - 30,000 BTU auto-ignition furnace
 - Electric fireplace (26M)
 - 6 gal. gas/electric DSI auto-ignition water heater
 - Jayco-exclusive, easy-operation legless dinette table
 - 2-point lap safety belts in all designated seating locations
 - Car seat leathers (select floorplans)
 - 10 cu. ft. 12V refrigerator
 - Furrer® all-in-one cooktop and oven
 - Residential-size microwave
 - Stainless steel kitchen sink
 - Decorative kitchen backsplash
 - Pop-up charging station with 120V outlet and USB plugs
 - LED-ill. pressed countertops
 - Shower with decorative ABS surround and skylight
 - Stainless steel bathroom sink
 - Toilet with foot flush
 - Vent fan in bathroom
 - Queen-size bed with bedspread (24B, 26XD, 29XX, 31F)
 - Queen-size power Murphy Bed (26M)
 - USB port and wireless charging in nightstands (26XD, 29XX, 31F)
 - USB port in cabinet over bed (24B, 26M)
 - Under-bed storage (select models)
 - Large wardrobes
 - Bunks with industry-exclusive 300 lb. capacity each (31F)
 - Smoke alarm
 - Carbon monoxide detector
 - Fire extinguisher

Base price	156,668.00
MODERN FARMHOUSE	443.00
USA STANDARDS	n/c
24 FD E45 14500 156*	n/c
7.3L WHITE RC10	6,000.00
CUSTOMER VALUE PACKAGE	1,193.00
DUAL ACS	3,893.00
HYDRAULIC AUTO LEVELING JACKS	3,893.00
200W ROOF MOUNTED SOLAR PANEL W/2ND HOUSE BATTERY*	893.00
STANDARD HOUSE BATTERY FOLDING WINDSHIELD SUN SHADE	n/c
DINETTE	488.00
	n/c

UNIT TOTAL 169,578.00

DEALER INSTALLED OPTIONS

Manufacturer's Suggested Retail Price \$169,578.00

TOTAL AMOUNT DOES NOT INCLUDE STATE AND LOCAL TAXES OR LICENSE FEES. THE PRICE SHOWN ABOVE MAY OR MAY NOT BE REPRESENTATIVE OF THE ACTUAL SELLING PRICE OF SIMILAR RECREATIONAL VEHICLES IN YOUR AREA.

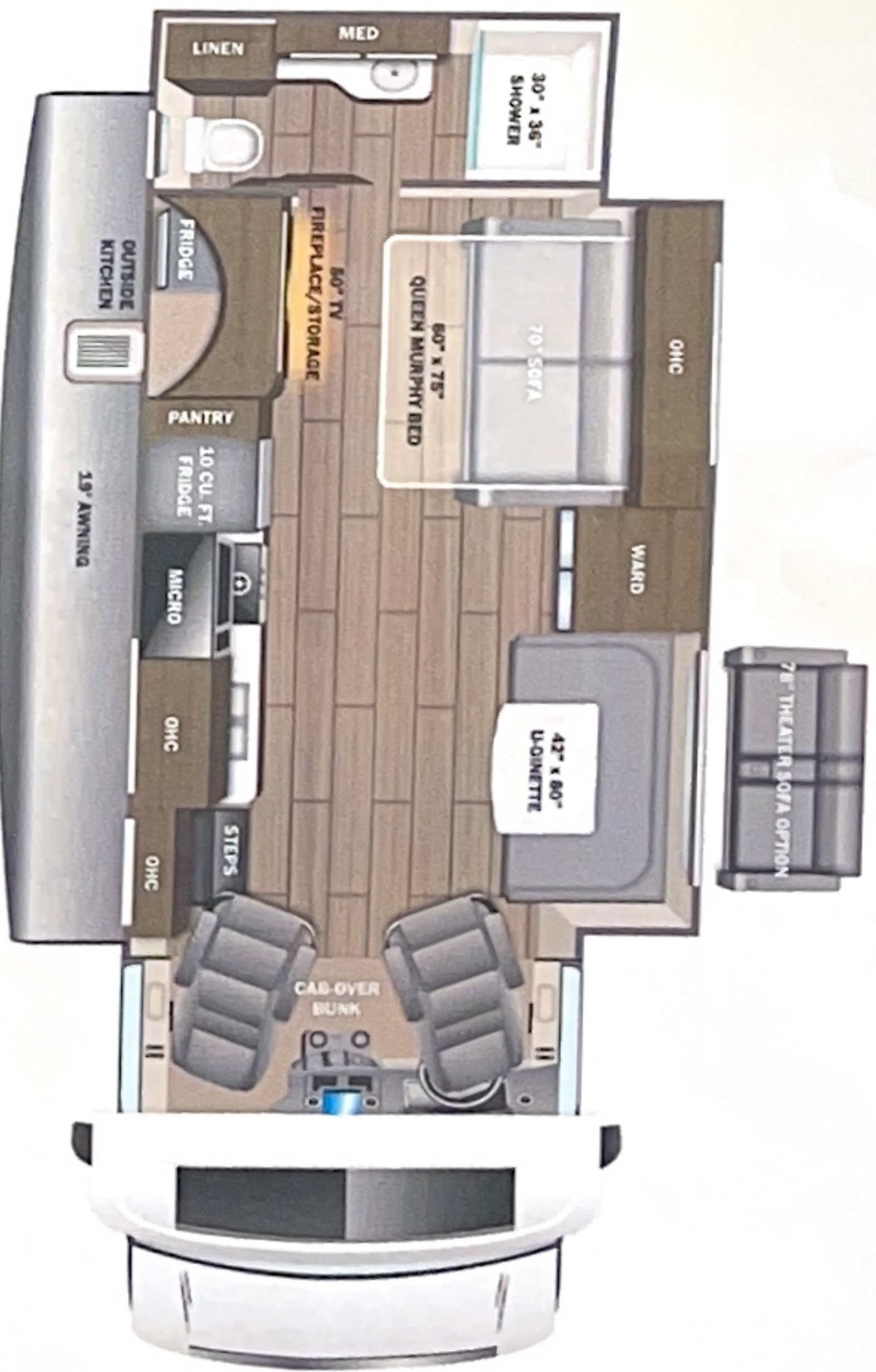

DIMENSIONS

Exterior height:.....138.00"
 Exterior width:.....100.00"

CAPACITIES

Fresh water tank (gals.):.....43.50
 Gray water tank (gals.):.....40.00
 Black water/coilet tank (gals.):.....31.00
 Propane (lbs.):.....41
 Propane (gals.):.....9
 Water heater (gals.):.....6.00

TIRES

Tire size (front):.....LT225/75R16E
 Tire size (mid):.....
 Tire size (rear):.....LT225/75R16E

Some dimensions may be rounded and may vary from the actual dimensions
 ***Weights may be estimated calculations and may vary from the actual weight
 - refer to the vehicle weight labels for actual weights***
 Floorplans, features and specifications are subject to change without notice.

