

**Highland**  
RIDGE RV

## Open Range Roamer



Serial #: 58TCH0BR5N3JA3090  
Model: 264RLS OPEN RANGE ROAMER FW

Model Year: 2022 Dealer Name: RV One Superstores Fleetwood  
14035 KUTZTOWN  
FLEETWOOD, PA 19522  
USA

### Standard Equipment

THE FOLLOWING ITEMS ARE STANDARD ON THIS MODEL  
AT NO EXTRA CHARGE

TERIOR  
00" wide body frame  
" receiver hitch  
-20 lb. LP bottles  
0 amp service  
CCU-SLIDE™ slide system (42" deep 4-corner  
mpression)  
attery disconnect switch  
rass hanger bushings with wet bolts  
qua-Flex® axle suspension  
terior grill hookup quick connect port  
aminated block foam floor  
VC roofing membrane (limited lifetime warranty)  
oof ladder  
elf-adjusting electric brakes  
pare tire  
uffShell™ - vacuum bonded laminated construction,  
iforced with heavy-duty fiberglass and welded  
ninum frames

UR SEASON PACKAGE (MANDATORY)  
ouble insulated baggage doors  
ucted heat to underbelly with cold air return  
nclosed cable operated gate valves  
nclosed exterior docking station with black tank  
h  
eated and enclosed underbelly  
igh performance furnace  
-38 reflective foil insulation in ceiling and  
erbelly  
-9 block foam insulation in sidewalls

#### INTERIOR

- 75 lb. ball bearing drawer guides
- 60" X 80" residential size queen bed with adjustable power base
- Cable and satellite prep
- Flush floor slides with residential vinyl flooring
- Large oven and 3-burner range with flush mount glass cover
- LED interior lighting
- Observation camera prep
- Residential microwave
- Roller blackout night shades
- Theater seating with heat and massage
- Wall controlled power vent (kitchen/living room area)
- Washer/dryer prep
- Wi-Fi ready

#### EXECUTIVE PACKAGE (MANDATORY)

- 15,000 BTU roof mounted A/C
- 76" X 28" entrance door
- AM/FM/HDMI/USB/AUX Bluetooth® sound bar stereo with outdoor zones speakers
- Cutting board and sink strainer
- Digital TV antenna
- Interior convenience center light
- Keyed-Alike® entry and baggage doors
- LED HDTV
- Marine grade exterior speakers (2)
- Painted fiberglass front cap with LED lighting and automotive tinted window
- Power awning with LED lighting
- Quick recovery gas/electric water heater
- Quick release fresh water drain
- Residential high-rise faucet with pull-down sprayer
- Single Basin stainless steel under-mount kitchen sink
- Solar prep
- Solid swing-down entry step
- Solid-surface kitchen countertops
- Stainless steel appliances
- TravelLINK™ - Smart RV system that allows for Bluetooth® control of awnings, lighting, slides, heating, cooling, auto-levelers and more
- USB/12V Charging Port

### Optional Equipment

OPTIONAL EQUIPMENT INSTALLED ON THIS MODEL  
BY MANUFACTURER

Base price	75,6
USA Standards	
Executive Package	6,0
Four Seasons Protection	
Package	7
RVIA	1
Non-Powered Vent Bedroom	
14 Cu. Ft. Residential Refrigerator	1,1
No Generator Prep	
No Bedroom TV	
WiFi Router	4
Windows Standard	
Power Fan Vent Bathroom	
4 Point Auto Leveling with JT Strong Arms	3,2

UNIT TOTAL

**87,48**

DEALER INSTALLED OPTIONS

# Manufacturer's Suggested Retail Price

\$87,482.00 161-1530

TOTAL AMOUNT DOES NOT INCLUDE STATE AND LOCAL TAXES OR LICENSE FEES. THE PRICE SHOWN ABOVE MAY OR MAY NOT BE REPRESENTATIVE OF THE ACTUAL SELLING PRICE OF SIMILAR RECREATIONAL VEHICLES IN YOUR AREA.

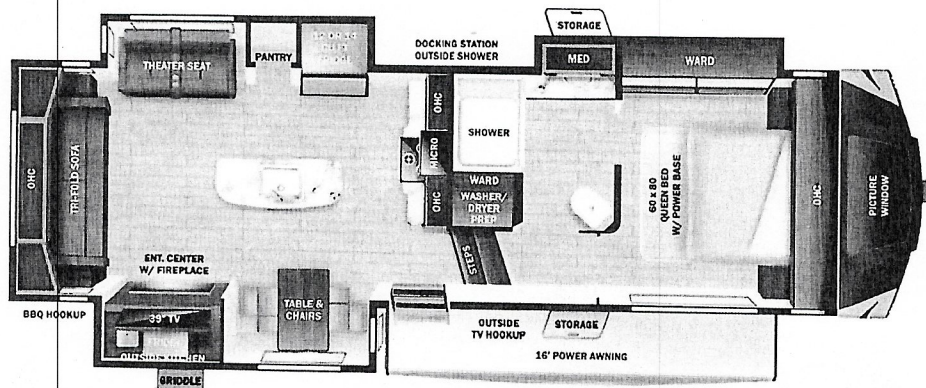

**UVW**

9910 lbs



**Sleeps**



**Length**

32' 7"

## DIMENSIONS

Exterior height:.....158.38"

Exterior width:.....100.00"

## WEIGHTS

GVWR:.....11500

GAWR (front):.....6000

GAWR (rear):.....6000

Approx. Gross Cargo Carrying

Capacity(GCCC):.....1590

## TIRES

Tire size (front):.....ST235/80R16E

Tire size (mid):.....

Tire size (rear):.....ST235/80R16E

## CAPACITIES

Fresh water tank (gals.):...75.00

Gray water tank (gals.):...97.00

Black water/toilet tank (gals):.....40.00

Propane (lbs.):.....60

Propane (gals.):.....14

Water heater (gals.):.....6.00

## SEATING & SLEEPING

Queen Bed:.....60 X 80

\*\*\*Some dimensions may be rounded and may vary from the actual dimensions\*\*\*

\*\*\*Weights may be estimated calculations and may vary from the actual weight

- refer to the vehicle weight labels for actual weights\*\*\*

Floorplans, features and specifications are subject to change without notice.

**3**  
**YEAR**  
LIMITED  
STRUCTURAL  
WARRANTY