

104-TUG 211

**Jay Feather**

Serial #: 1UJBB0BN7P1JW0134  
 Model: 22BH JAY FEATHER TT

Model Year: 2023 Dealer Name: ORLANDO RV  
 485 S.R. 436  
 CASSELBERRY, FL 32707  
 USA



**Manufacturer's Suggested Retail Price \$48,293.00**

TOTAL AMOUNT DOES NOT INCLUDE STATE AND LOCAL TAXES OR LICENSE FEES. THE PRICE SHOWN ABOVE MAY OR MAY NOT BE REPRESENTATIVE OF THE ACTUAL SELLING PRICE OF SIMILAR RECREATIONAL VEHICLES IN YOUR AREA.

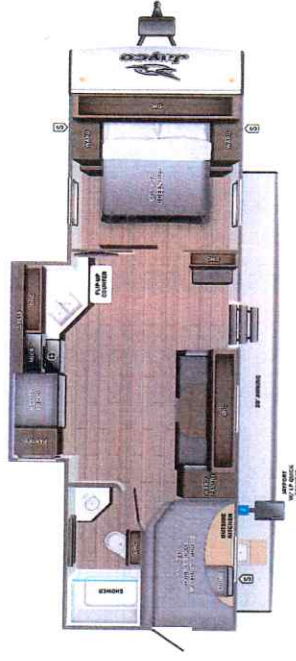

**lb** UUV 5660 lbs **Length** 28' 10"



**Dimensions**  
 Exterior height: .128.00\* Fresh water tank (gals.): .55.00  
 Exterior width: .96.00\* Gray water tank (gals.): .61.00

**WEIGHTS**  
 GVWR: .7500 Black water/toilet tank  
 GAWR (front): .3500 Propane (lbs.): .30.50  
 GAWR (rear): .3500 Propane (gals.): .40  
 Approx. Gross Cargo Carrying Capacity (GCCC): .1840 Water heater (gals.): .0.25

**TIRES**  
 Tire size (front): .ST205/75R14D  
 Tire size (mid):  
 Tire size (rear): .ST205/75R14D  
 Tire size (spare): .ST205/75R14D



\*\*\*Some dimensions may be rounded and may vary from the actual dimensions\*\*\*  
 \*\*\*\*Weights may be estimated calculations and may vary from the actual weight - refer to the vehicle weight labels for actual weights\*\*\*  
 Floorplans, features and specifications are subject to change without notice.

**Optional Equipment**

OPTIONAL EQUIPMENT INSTALLED ON THIS VEHICLE BY MANUFACTURER

Base price	43,418.00
Modern Farmhouse	n/c
USA Standards	n/c
Customer Value Package	4,875.00
Jay Sport Package	n/c
Solar Power Package Prep	n/c
No Jay/Command Control System	n/c
8 AMP Service	n/c
8 Ct. Ft. 12V Refrigerator	n/c
20# LP Gas Bottles	n/c
Roof Ladder (Std)	n/c

**Standard Equipment**

THE FOLLOWING ITEMS ARE STANDARD ON THIS MODEL AT NO EXTRA CHARGE

- EXTERIOR**
  - Aerodynamic, rounded front profile with diamond idemill
  - Modern retro graphics package with two-colored vinyl
  - Stronghold VET™ vacuum-bonded, laminated side and rear walls (including slat-out room walls)
  - 2 in. vacuum-bonded floor with 2 lb. foam insulation
  - Keyed-Allie™ lock system
  - Allpnum Trugs™ Floor System with one-piece aluminum I-beam frame with integrated frame
  - Full size safety-glass windows
  - Marine-grade exterior speakers with blue LED accent lighting (2)
  - Galvanized steel and impact-resistant wheel wells
  - Outside grill propane quick-connect port
  - LCI Solid Step® fold-down aluminum tread entry steps
  - Slide camp kitchen (standard on select models)
  - Side topper prep (select models with slide rooms)
  - Exterior TV bracket with 120V electric and cable jacks
- PORT PACKAGE (MANDATORY)**
  - Aluminum tread fold-down entry step
  - Deluxed graphics package
  - Floor mats
  - Glacier Package includes enclosed underbelly 32 in. or 39 in. LED Smart TV
  - Drying rack/bank cover
  - Power roof vent (main living area)
- INTERIOR**
  - Choice of two interior design packages- Modern Farmhouse or Vintage Washed Grey
  - LED lighting throughout
  - Screened and glazed cabinets
  - Residential vinyl flooring with cold crack resistance
  - Full wood dinette, bunk and bed bases (applicable models)
  - 8 cu. ft. 12V refrigerator
  - Residential oven with 3-burner recessed cooktop and glass cover
  - Residential-style kitchen countertops
  - Microwave
  - Decorative backsplash
  - 4 in. high-density dinette cushions with vinyl backing
  - Bed mats (select models) "lean" soft-touch residential-style
  - 120V outlet and cargo net in fixed bunks
  - Plastic foot flush toilet
  - Wood panel interior
  - Wood panel ledge inserts
  - Decorative roller shades with reflective backer
- CUSTOMER VALUE PACKAGE (MANDATORY)**
  - American-made nitro-filled Goodyear radial tires with self-adjusting electric brakes
  - Aluminum rims
  - Spare tire
  - 15 000 BTU AC
  - Detachable power cord
  - Black awning with LED lights
  - Outside shower
  - Power tongue jack
  - Rock Solid stabilizer system
  - T-Top
  - 65 sp. fresh water tank
  - AM/FM/Bluetooth® stereo
  - Side-marker camera prep
  - Inverter pre-wire

UNIT TOTAL 48,293.00

DEALER INSTALLED OPTIONS